

FEATURES & SPECIFICATIONS

INTENDED USE — The MS Series LED is a linear solution ideal for open-ceiling or suspended applications with mounting heights from 14 to 20 feet. Available as a complete luminaire, based on the time-tested MS housing, the traditional fixture design offers time-saving installation options making it a favorite for contractors. It can be mounted in a continuous row or as a stand-alone unit. Its full-body construction and multiple mounting options adapt to a wide variety of suspended and open-ceiling applications.

Certain chemicals that may exist in end-user locations release airborne contaminants that can impact the integrity and safety of key fixture components. Please refer to the environmental compatibility chart located in the Product Selection Guide and/or the company website to ensure that these chemical interactions are considered when selecting fixtures. For additional information please consult an authorized factory representative. **Certain airborne contaminants can diminish integrity of acrylic.** [Click here for Acrylic Environmental Compatibility table for suitable uses.](#)

CONSTRUCTION — The full-body housing and optical assembly is precision-formed using 20-gauge steel. The optical assembly ships factory-installed into the housing and utilizes aircraft cable tethers to support the optical assembly during wiring. The lensing integrates seamlessly into the optical housing to provide a sealed chamber to mitigate dust and insect collection. A convenient access plate is located on the back of the channel for access to the wiring compartment.

Finish: High-gloss, baked white enamel finish. Five-stage iron phosphate pretreatment ensures superior paint adhesion and rust resistance.

OPTICS — Optical design distributes the light in the 0-60 deg. zone, which provides better utilization of light on task. Each linear bar is outfitted with premium, anodized MIRO 5° aluminum to ensure the highest lumens per watt can be achieved. A diffuse acrylic lens eliminates the pixels to minimize glare and improve uniformity.

ELECTRICAL — The MSL luminaire has 94% lumen maintenance at 60,000 hours with an expected life of greater than 100,000 hours. The MSL ships standard with a thermally protected dimming driver that dims down to 5% using 0-10V controls. Optional EldoLED driver allows for flicker-free dimming down to 1%. Please refer to www.synergylightingcontrols.com/ProductBrochures.aspx for dimming solutions. You may also contact the Synergy Support at 800-533-2719 or Support@SynergyLightingControls.com. LEDs are driven to provide optimal lumens per watt and less heat to extend component life. The driver and optical housing are connected with mating plug for easy removal or future upgrade. Optional 12AWG through-wire harnesses is available for continuous-row installations.

INSTALLATION — A variety of mounting arrangements are available including tong hangers, aircraft cables and stems. Suitable for mounting in continuous-row or individual mounting. End caps include knockouts for through wiring and fixture attachment in row-mounting applications.

LISTINGS — UL and cUL listed to US and Canadian standards. For use in damp and dry locations with ambient temperatures ranging from -20°C (-4°F) to 30°C (86°F)

Catalog Number
Notes
Type



LED Low Bay

MSL

COMPLETE LUMINAIRE
4' or 8' Lengths



SPECIFICATIONS				
All dimensions are shown in inches (centimeters) unless otherwise noted.				
Series	Length	Width	Depth	Weight
TMSL	96 (243.8)	10 (25.4)	3-1/4 (8.26)	26 lbs. (11.8 kg)
MSL	48 (121.9)	10 (25.4)	3-1/4 (8.26)	13 lbs. (5.9 kg)

WARRANTY — 5-year limited warranty. Complete warranty terms located at www.acuitybrands.com/CustomerResources/Terms_and_conditions.aspx

Actual wattage may differ by +/- 10% when operating between 120-277V +/- 10%.

Actual performance may differ as a result of end-user environment and application.

Note: Specifications subject to change without notice.

ORDERING INFORMATION

Lead times will vary depending on options selected. Consult with your sales representative.

Example: MSL 4000LM L/LV MVOLT GZ10 40K 80CRI WH

Series	Lumens	Louver	Voltage	Driver	Color temperature	Color rendering index				
MSL	4000LM	4000 lumens	MVOLT	GZ10	30K	80CRI				
	8000LM	8000 lumens ¹					120V	EZ1	35K	90CRI
	10000LM	10000 lumens ¹					277V	0-10V dimming EldoLED 1-100% dimming	40K	80 CRI
TMSL	8000LM	8000 lumens	347V ²	30K	80 CRI					
	16000LM	16000 lumens ¹	480V ²			3500 K	90 CRI			
	20000LM	20000 lumens ¹				4000 K				
					50K					

Options				Finish
PLR1G	Single-circuit, plug-in wiring ³	<u>Cord sets:</u>	<u>Motion sensors:</u>	WH White MB Matte black
PLR22G	Two-circuit alternating plug-in wiring ³	CS1W	LCOZU	
PLR1LVG	Single-circuit plug-in wiring with low voltage leads ³		LCHOSZU	
GLR	Internal fast-blow fuse ⁴	CS11W	LCPZU	
CRE	Continuous row end; one hole for wiring to row, one flattened knockout to terminate the row ⁵		LAOZU	
CRM	Continuous row middle; both end plates have holes for row wiring ³	CS93W	LAHOSZU	
			LAPZU	

See footnotes on page 2.

MSL LED Low Bay

Accessories: Order as separate catalog number.	
ZAC	Canopy, no power feed ⁶
ZACF	Canopy and power feed for beginning of row ⁶
ZACVH	Aircraft 10' V hanger (one pair)
SQ_	Swivel-stem hanger (specify lengths in 2" increments)
THMSSHB	Tong hangers
WGMS8Z	4' wire guard, zinc coated (offers light-duty protection)
HC36	Hanger chain, 36"

Notes

- 1 Not available with EZ1 driver.
- 2 347 and 480V utilize a step-down transformer.
- 3 Requires CRE or CRM option.
- 4 Must specify voltage.
- 5 Not available with sensor options.
- 6 One cable per package.

OPERATIONAL DATA

Lumen package	Ambient rating (120V - 277V)	Driver compatibility	Delivered lumens						Watts		Comparable light source
			3500 K CCT, 80 CRI	4000 K CCT, 80 CRI	5000 K CCT, 80 CRI	3500 K CCT, 90 CRI	4000 K CCT, 90 CRI	5000 K CCT, 90 CRI	80 CRI	90 CRI	
MSL 4000	-4°F to 86°F (-20°C to -30°C)	EZ1 and GZ10	4,055	4,036	4,110	3,471	3,455	3,518	34	37	1-lamp 54T5HO, 2-lamp 32T8, 70-100W HID
MSL 8000	-4°F to 86°F (-20°C to -30°C)	GZ10	8,239	8,200	8,350	7,053	7,020	7,149	74	79	2-lamp 54T5HO, 4-lamp 32T8, 150-175 HID
MSL 10000	-4°F to 86°F (-20°C to -30°C)	GZ10	8,985	8,943	9,107	7,692	7,656	7,796	80	86	3-lamp 54T5HO, 4-lamp 32T8, 150-175 HID
TMSL 8000	-4°F to 86°F (-20°C to -30°C)	EZ1 and GZ10	8,110	8,072	8,220	6,943	6,910	7,037	69	73	2-lamp 54T5HO, 4-lamp 32T8, 150-175 HID
TMSL 16000	-4°F to 86°F (-20°C to -30°C)	GZ10	16,477	16,400	16,701	14,106	14,040	14,298	148	158	4-lamp 54T5HO, 8-lamp 32T8, 250 HID
TMSL 20000	-4°F to 86°F (-20°C to -30°C)	GZ10	17,970	17,886	18,214	15,384	15,312	15,593	161	172	6-lamp 54T5HO, 8-lamp 32T8, 250-315 HID

PROJECTED LUMEN MAINTENANCE

Operating hours	0	10,000	20,000	30,000	40,000	50,000	60,000	100,000
Lumen maintenance factor	1	0.99	0.98	0.97	0.96	0.95	0.94	0.91



MSL

MOUNTING DATA

For unit or row installation, surface or stem mounting.

Unit installation — Minimum of two hangers required.

Row installation — One hanger per channel plus one per row required.

Hanging devices illustrated below.

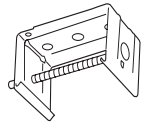

THM55HB

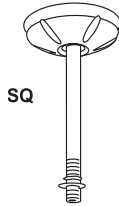

SQ

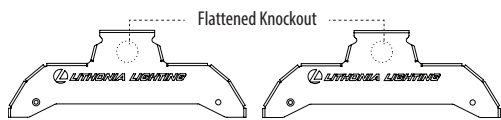

Blank - Standard option

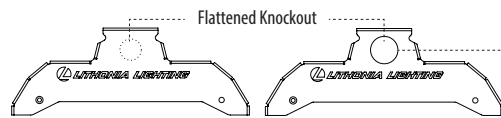

CRE - Continuous Row End (for beginning of row)

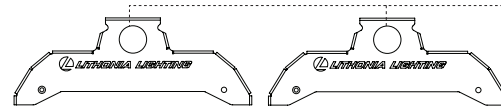

CRM - Continuous Row Mount (for middle fixture)

1-1/8" Hole

DIMENSIONS

All dimensions are in inches (centimeters) unless otherwise indicated.

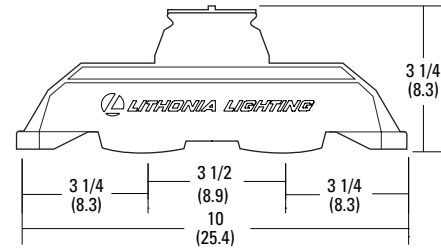
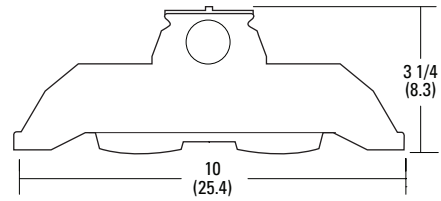

- A = 7/8 (2.2) KO
- B = 3/4 (1.9) KO
- C = 2-3/8 (6.0)
- D = 1-1/4 (3.2)
- E = 2-3/8 (6.0)
- F = 1-3/8 (3.5)

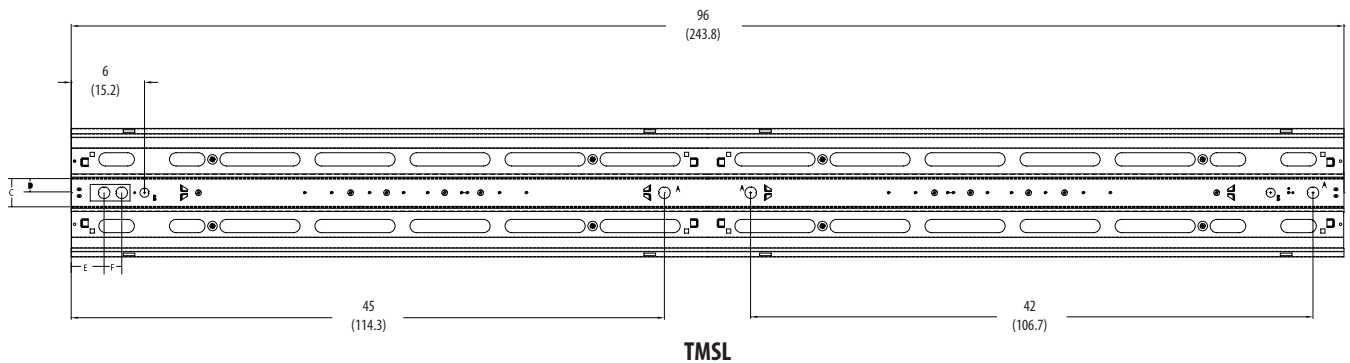
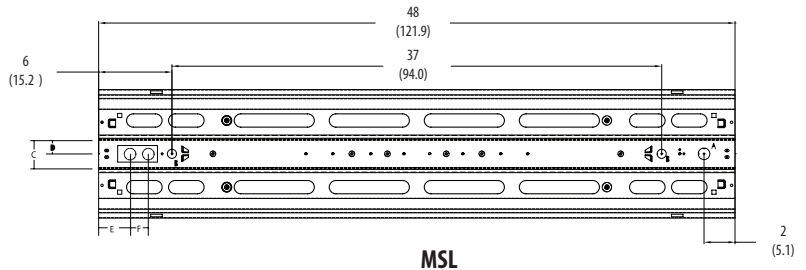

PHOTOMETRICS

See www.lithonia.com.

LSXR - Fixture Mount Sensor (see www.sensorswitch.com for additional information)

- Four interchangeable lenses.
- Integrated mounting bracket drops lens down 3" from chase nipple.
- Single or dual relay versions — designed with robust protection from the harsh switching requirements of T5 and LED loads.
- Photocell and 0-10VDC dimming options.
- No PIR field calibration or sensitivity adjustments required.



LSXR configuration	Comparable CMRB sensor	Old style sensor nomenclature
For shortest lead times use one of the following LSXR configurations		
LCOZU	CMRB 50	MSI
LCHOSZU	CMRB 50 D	MSID
LCPZU	CMRB 50 P	MSIPED
LAOZU	CMRB 6	MSI360
LAHOSZU	CMRB 6 D	MSI360D
LAPZU	CMRB 6 P	MSI360PED

SELECTIONS BELOW WILL EXTEND ORDER LEAD TIME. CONSULT YOUR SALES REPRESENTATIVE FOR DETAILS.

SINGLE RELAY

ORDERING INFORMATION

Lead times will vary depending on options selected. Consult with your sales representative.

Example: LAHOSZU

Series	Lens option	Dimming/Photocell	Max. dim Level	Min. dim level	Temp/Humidity	Default time delay
L LSXR passive infrared indoor occupancy sensor	A High mount, 360°	O None ¹	0 10 VDC	5 Minimum dimming level of ballast	Z None	I 30 seconds
	B Low mount, 360°	H High/low occupancy operation	9 9 VDC	1 1 VDC	T Low temperature	D 2.5 minutes
	C High mount aisleway	P Switching photocell (on/off)	8 8 VDC	2 2 VDC		X 5 minutes
		M Dimming and switching photocell	7 7 VDC	3 3 VDC		R 7.5 minutes
		G Dimming and switching photocell with high/low occupancy operation		4 4 VDC		U 10 minutes (with minimum 15 minutes on time)
				5 5 VDC		V 15 minutes
				6 6 VDC		W 20 minutes
					Y 30 minutes	

DUAL RELAY (Available with 120, 277, and 347V only)

ORDERING INFORMATION

Lead times will vary depending on options selected. Consult with your sales representative.

Example: LA2KZU

Series	Lens option	Poles	Operating mode	Temp/Humidity	Default time delay
L LSXR passive infrared indoor occupancy sensor	A High mount, 360°	2 Dual relay	J None	Z None	I 30 seconds
	B Low mount, 360°		K Alternating off relays (promotes even lamp wear)	T Low temperature	D 2.5 minutes
	C High mount aisleway		O Alternating off relays w/photocell		X 5 minutes
			P Switching photocell (on/off)		R 7.5 minutes
			E Photocell on/off (pole 1 only)		U 10 minutes (with minimum 15 minutes on time)
			F Photocell on/off - both poles (dual set-point)		V 15 minutes
				W 20 minutes	
				Y 30 minutes	

Example: LENS 50 J100

Replacement lenses: Order as separate catalog number.		
Series	Lens type	Package quantity
Lens	6 High mount 360°	U Unit
	10 Low mount 360°	J10 10-pack
	50 High mount aisleway	J100 100-pack

Notes

- 1 Dimming level fields not required when this option is chosen.