

IECC 2015 DESIGN GUIDE

PUBLIC RESTROOM WITH LOW VOLTAGE CEILING SENSORS

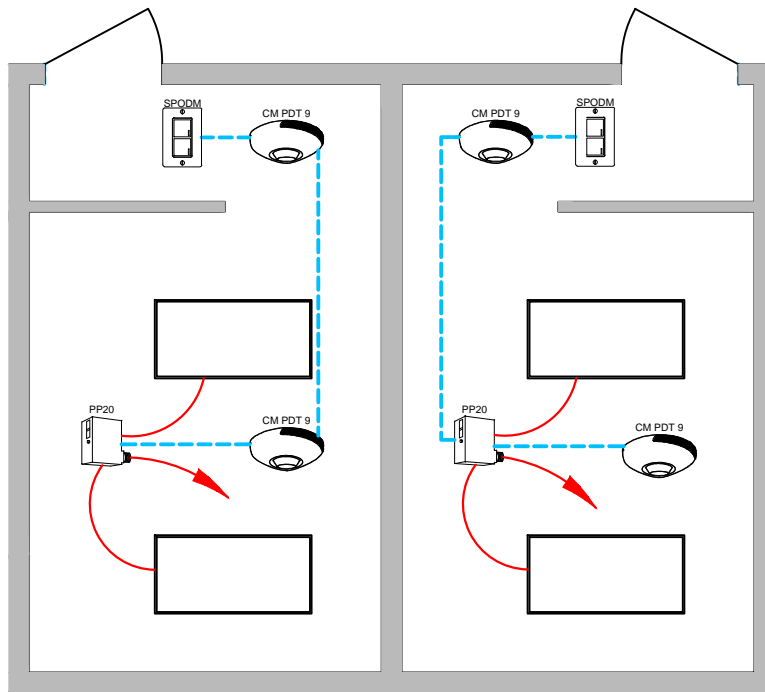

SENSOR SWITCH



SEQUENCE OF OPERATION:

LIGHTS

- ALL LIGHTS ARE SWITCHING
- ALL FIXTURES ARE CONTROLLED TOGETHER (PER ROOM)

OCCUPANCY

- LIGHTS AUTOMATICALLY TURN ON WHEN OCCUPANT ENTERS
- LIGHTS AUTOMATICALLY TURN OFF WHEN ROOM BECOMES VACANT

MANUAL

- MASTER ON/OFF

ADDITIONAL OPTIONS:

- SURFACE OR RECESSED MOUNT SENSORS ALSO AVAILABLE
- FOR EMERGENCY LIGHTING CONTROL ADD A PP16 SHUNT PACK.

DIAGRAM LEGEND

CAT-5e CABLE

LINE FEED

BILL OF MATERIAL (per room)

QTY	PRODUCT #	DESCRIPTION
1	PP20	RELAY MODULE
1	SPODM	ON/OFF WALL POD
2	CM PDT 9	DUAL TECHNOLOGY OCCUPANCY SENSOR

SUPPORTS THE FOLLOWING REQUIREMENTS:

FULL AUTO-OFF VIA OCCUPANCY SENSOR (C405.2.1.1)

LOCAL SWITCH (C405.2.2.3)