



FEATURES & SPECIFICATIONS

INTENDED USE — The PS750DL multi-volt (120V thru 277V; 50-60hz) emergency LED driver is designed to provide a minimum of 90 minutes of illumination for LED luminaires during the loss of normal AC power. It is UL recognized for factory installation inside indoor, damp or sealed and gasketed wet location listed LED luminaires utilizing 7 watts maximum output power, 50 VDC maximum output voltage and an output current of 140 mA.

CONSTRUCTION

UL rated, painted steel enclosure

Flexible metallic conduit

U.S. Patent No. 6,522,147; 6,577,136

PERFORMANCE — When normal AC power fails, the PS750DL immediately drives the LED load at a reduced light output for a minimum of 90 minutes. When AC power is present, the emergency LED driver operates in various charging modes to ensure the sealed, maintenance-free, high-temperature nickel-cadmium batteries are fully recharged within 24 hours after a discharge and remains fully charged until the next loss of AC power. The test switch/pilot light provides visual and manual means of monitoring the system operation.

ELECTRICAL

Multi-volt input capability – 120V thru 277V; 50-60hz

Output current – 140 mA

Maximum Output Voltage – 50 VDC

Maximum Output Power – 7 watts

Maximum AC input – 290 mA and 3.3 watts

INSTALLATION — Flexible metal conduit allows for mounting inside or outside of wireway. One 1/2" hole in fixture channel permits mounting of test switch/pilot light behind fixture lens.

Compact size (11.8" L x 2.18" W x 1.18" H) fits in a variety of LED fixtures: troffers, volumetric recessed, industrials, commercials, downlights and strips

Unit wires two ways: on night light circuit (permanently energized) or on switchable circuit (unswitched circuit to battery charger and switched circuit to the fixture driver).

Ambient temp rating 5 °C to 55 °C (41 °F to 131 °F)

Polarized quick-connect test switch/pilot light assembly simplifies installation

Standardized mounting centers

LISTINGS — UL recognized (pending). Meets UL 924, NFPA 101 (current Life Safety Code), NEC and OSHA illumination standards

UL 1310, Class 2 LED Emergency Driver

Standard unit is UL recognized for installation in damp or wet location sealed and gasketed listed luminaires

Not suitable for mounting outside the luminaire in a wet location application

Catalog Number
Notes
Type

PS750DL

LED Emergency Battery Backup

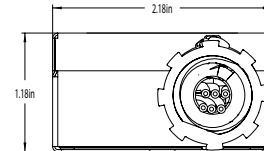

MOUNTING

All dimensions are in inches.

Enclosure Length: 11.8"

Shipping weight: 2.5 lbs. (1.14kg)

WARRANTY — 5-year limited warranty. Complete warranty terms located at www.acuitybrands.com/CustomerResources/Terms_and_conditions.aspx

Note: Actual performance may differ as a result of end-user environment and application. Specifications subject to change without notice.

ORDERING INFORMATION

Lead times will vary depending on options selected. Consult with your sales representative.

Example: PS750DL

PS750DL	
Series	Options
PS750DL Power Sentry 7W max output wattage 50V DC output voltage DL form factor	SD Self-diagnostics ¹

Accessories: Order as separate catalog number. ²	
ELA TSPLP	Remote or replacement test switch pilot light; mounts up to 25' away from fixture
ELA TSPLPSD	Remote or replacement test switch pilot light for self-diagnostics; mounts up to 25' away from fixture
ELA PSMKSD	External mounting kit for self-diagnostics module (2 required per module)

Notes

- 1 Self-diagnostics (PSSD2) module ships separately. See [PSSD2](#) Accessories spec sheet for details on self-diagnostics.
- 2 See accessories specification sheets for details on other compatible devices ELA-RTS-TSPLP-PSTS-PSPRSB and ELA-PSMK-PSMKSD-PSDMT-PSRME

PS750DL LED Emergency Battery Backup

SPECIFICATIONS

BATTERY				
Sealed Nickel-Cadmium				
Voltage	Typical Shelf life ¹	Typical life ¹	Maintenance	Ambient temperature ²
4.8V	3 years	7-10 years	none ³	0-50C (32-122° F)

Notes

- 1 At 77°F Ambient temperature, charge/discharge cycles and prolonged full discharge may reduce useful life.
- 2 Ambient temperature range where unit will provide capacity for 90 minutes. Higher and lower temperatures affect life and capacity.
- 3 All life safety equipment, including emergency lighting for path of egress must be tested in accordance with all National Fire Protection Association (NFPA) and local codes. Failure to perform the required testing could jeopardize the safety of occupants and will void all warranties.

KEY OPTIONS

Self Diagnostics Module PSSD2



PS750DL