

CONTENTS

LED	
LED Downlighting.....	318-319
VOLUMETRIC	
Recessed Volumetric Downlighting.....	320-321
COMPACT FLUORESCENT	
8" CFL Horizontal.....	322-324
8" CFL Vertical.....	325
6" CFL Horizontal.....	326-328
6" CFL Vertical.....	329
METAL HALIDE	
8" Metal Halide.....	330-331
6" Metal Halide.....	332-333
INCANDESCENT	
8" Incandescent.....	334
6" Incandescent.....	335
LOW VOLTAGE	
6" Low Voltage.....	336
OPTIONS & ACCESSORIES	337

DOM8 LED

8" LED Downlight



Intended Use

The DOM™ Series integrates new technology and quality materials to maximize performance and aesthetics while ensuring the quality of light. This series is ideal for supplying high-quality general illumination in corridors, offices, reception areas, schools and retail environments. The DOM is 20% more energy efficient than comparable CFL downlights.

Construction

16-gauge galvanized steel mounting/plaster frame with torsion springs to mount the open conical shape reflector.

Rugged, one-piece, die-cast housing with white interior dome reflector.

LED light source shielded from direct view.

Vertically adjustable mounting brackets for use with 16-gauge flat barhangers (included), C channel or 1/2" steel conduit. Provides 3-3/4" total adjustment.

Post-installation adjustment possible from above or below the ceiling.

Galvanized steel junction box with bottom-hinged access covers and spring latches. Two combination 1/2"-3/4" and three 1/2" knockouts for straight-through conduit runs. Capacity: 8 (4 in, 4 out) #12 AWG conductors, rated for 90°C.

Fixture height of 5-3/4" allows installation in shallow plenum applications. Secondary housing adjustment system for precise, final ceiling-to-flange alignment.

Electrical

The system maintains 70% lumen output at more than 50,000 hours.

Utilizes high-brightness LEDs mounted to a metal core circuit board, ensuring efficient heat dissipation, 3500K, CRI > 80.

Thermal protection provided against improper insulation use.

High-efficiency, electronic LED driver mounted in the junction box.

Luminaire should be installed in applications where ambient temperatures do not exceed 50°C. Ambient temperatures that exceed 50°C will result in reduced lamp life and will void warranty.

Listings

Fixtures are UL Listed for through-branch wiring, Non-IC recessed mounting, damp location, and to U.S. and Canadian safety standards.

Three-year limited warranty.



ORDERING INFORMATION

Lead times will vary depending on options selected. Consult with your sales representative.

Example: DOM8 LED 1200L 120 D08

Series	Lumen output ¹	Color temperature	Voltage	Reflector	Options
DOM8 LED	1200L	(blank) 3500K	120	D08 White open ²	DIM 0-10V dimming driver, 10% minimum light output
	1500L		277	D08A Clear diffuse open	LBH Less barhangers
			347	D08AZ Semi-specular open	TRW White flange with anodized reflectors
				D08MW Matte white ²	TRBL Black flange with anodized reflectors

ADDITIONAL INFORMATION

For additional product information, visit www.lithonia.com.

Drawings are for dimensional detail only and may not represent actual mechanical configuration. Dimensions are shown in inches (centimeters) unless otherwise noted.

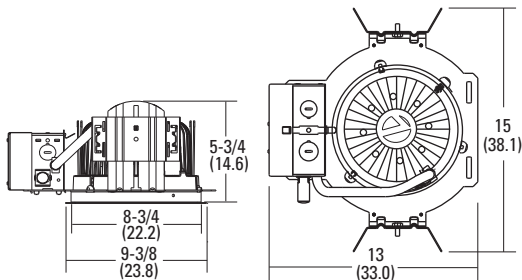

Notes

- Total system delivered lumens.
- White integral flange.

DOM6 LED

6" LED Downlight



PRODUCT INFORMATION

Intended Use

The DOM™ Series integrates new technology and quality materials to maximize performance and aesthetics while ensuring the quality of light. This series is ideal for supplying high-quality general illumination in corridors, offices, reception areas, schools and retail environments. The DOM is 20% more energy efficient than comparable CFL downlights.

Construction

16-gauge galvanized steel mounting/plaster frame with torsion springs to mount the open conical shape reflector.

Rugged, one-piece, die-cast housing with white interior dome reflector.

LED light source shielded from direct view.

Vertically adjustable mounting brackets for use with 16-gauge flat barhangers (included), C channels or 1/2" steel conduit. Provides 3-3/4" total adjustment.

Post-installation adjustment possible from above or below the ceiling.

Fixture height of 5-3/4" allows installation in shallow plenum applications. Secondary housing adjustment system for precise, final ceiling-to-flange alignment.

Electrical

The system maintains 70% lumen output at more than 50,000 hours.

Utilizes high-brightness LEDs mounted to a metal core circuit board, ensuring efficient heat dissipation, 3500K, CRI > 80.

Thermal protection provided against improper insulation use.

High-efficiency, electronic LED driver mounted in the junction box.

Luminaire should be installed in applications where ambient temperatures do not exceed 50°C. Ambient temperatures that exceed 50°C

will result in reduced lamp life and will void warranty.

Listings

Fixtures are UL Listed for through-branch wiring, Non-IC recessed mounting, damp location, and to U.S. and Canadian safety standards.

Three-year limited warranty.



ORDERING INFORMATION

Lead times will vary depending on options selected. Consult with your sales representative.

Example: DOM6 LED 900L 120 D06

Series	Lumen output ¹	Color temperature	Voltage	Reflector	Lens ⁴	Options
DOM6 LED	600L 900L ²	(blank) 3500K	120	D06 White open ³	DL61 White splay, flat clear lens	DIM 0-10V dimming driver, 10% minimum light output ELRB722 Emergency battery pack; switch provided ² LBH Less barhangers TRW White flange with anodized reflectors TRBL Black flange with anodized reflectors
			277	D06A Clear diffuse open	DL6B1 Black baffle, flat clear lens	
			347	D06AZ Semi-specular open	DL64 White splay, fresnel lens	
				D06MW Matte white ³	DL6B4 Black baffle, fresnel lens DL673 White splay, tempered prismatic lens DL6B73 Black baffle, tempered prismatic lens	

ADDITIONAL INFORMATION

For additional product information, visit www.lithonia.com.

Drawings are for dimensional detail only and may not represent actual mechanical configuration. Dimensions are shown in inches (centimeters) unless otherwise noted.

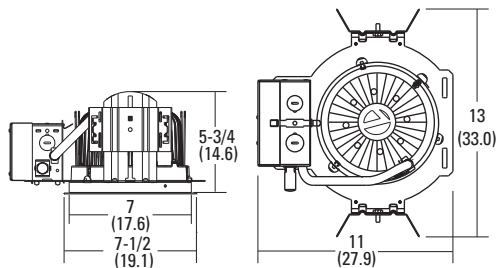

Notes

- Total system delivered lumens.
- ELRB722 available with 900L only.
- White integral flange.
- Lensed reflectors are wet location listed.

RT5D LED



Intended Use

The RT5D Series is designed for applications where comfort, aesthetics and energy savings are important.

The RT5D LED is 20% more efficient when compared to the mean efficacy of a common two-lamp, 26DTT compact fluorescent downlight.

Construction

16-gauge galvanized steel mounting plaster frame with mechanical trim retention integral yoke to retain optical system. Fixture height of 4- 7/8" allows installation in shallow plenum applications.

Maximum 2" ceiling thickness.

Optics

Regressed, two-piece refractive system obscures the lamp and smoothly washes the reflector with light. Rugged, one-piece white die-cast reflector system with linear facets softens and distributes light into the space (ships separately).

Electrical

The system maintains 70% lumen output at more than 50,000 hours. Utilizes high-efficiency LEDs mounted to a metal core circuit board, ensuring cool-running

operation, 3500K, CRI > 80. Typical lumens per system is 1700 utilizing 41 total system watts.

Listings

Fixtures are UL Listed for through-branch wiring, Non-IC recessed mounting, damp location, and to U.S. and Canadian safety standards.

Three-year limited warranty.



Example: RT5D LED

ORDERING INFORMATION Lead times will vary depending on options selected. Consult with your sales representative.

Series	Lumen output	Color temperature	Voltage	Options
RT5D LED	(blank) 1700L ¹	(blank) 3500K	120 277 347	CP Chicago plenum LFS LED freezer shroud (shipped separately) ² S5 SIMPLY5™ energy management system ³ SSHW Hardwire for SIMPLY5™ system; replaces RELOC® wiring ³

ADDITIONAL INFORMATION For additional product information, visit www.lithonia.com.

Drawings are for dimensional detail only and may not represent actual mechanical configuration. Dimensions are shown in inches (centimeters) unless otherwise noted.

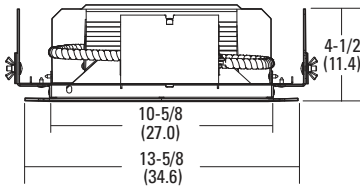

Notes

- 1 Typical system delivered lumens.
- 2 Available for use only with freezer applications.
- 3 SIMPLY5™ includes 9" S5 MLC RELOC wiring system (shipped separately); available 120 or 277V only.

PRODUCT INFORMATION

Intended Use

Provides volumetric lighting by filling the entire volume of space with light, delivering the ideal amount of light to walls, cubicles, work surfaces and people. Typical applications include corridors, lobbies, conference rooms and private offices. RT5D will fill the space with light without glare or cave effect of traditional downlights. In addition, RT5D with a single 32W triple-tube lamp provides up to 30% energy savings when compared to common two-lamp, 26W double twin-tube downlight.

Construction

16-gauge galvanized steel mounting/plaster frame

with mechanical trim retention integral yoke to retain optical system.

Rugged, one-piece white die-cast reflector system with linear facets softens and distributes light into the space (ships separately).

Mounting bars are 16-gauge galvanized steel with continuous 2-3/4" vertical adjustment, held in place with wingnuts. Post installation adjustment possible without the use of tools from above or below the ceiling.

Galvanized steel junction box with bottom-hinged access covers and spring latches.

Two combination 1/2"-3/4"

and three 1/2" knockouts for straight-through conduit runs. Capacity: 8 (4 in, 4 out) #12 AWG conductors, rated for 90°C.

Maximum 2" ceiling thickness.

Optics

Regressed, two-piece refractive system obscures the lamp and smoothly washes the reflector with light.

Impact-modified acrylic prismatic refractor with polymer light diffusing film.

Electrical

Horizontally mounted, four-pin, positive-latch, thermoplastic socket.

Class P, thermally protected high power factor electronic ballast mounted to the junction box (EL battery back mounted on ballast tray). Minimum starting temperature is 0°F/-18°C.

SS option available for use with SIMPLY5™ lighting intelligence system with multi-level dimming. See SYNERGY® Lighting Controls specification sheets for more information.

Listings

Fixtures are UL Listed for through-branch wiring, Non-IC recessed mounting, damp location, and to U.S. and Canadian safety standards.

RT5D

1'x1' Horizontal Lamp, Triple-Tube (TRT)



ORDERING INFORMATION

For shortest lead times, configure products using **bolded options**.

Example: RT5D

Series	Lamp type	Voltage	Options
RT5D	(blank) 1/26-42TRT1	(blank) MVOLT ²	EL Emergency battery pack; integral test switch provided ^{4,5}
	1/26TRT One 26W TRT lamp	120 120V ³	ELR Emergency battery pack; remote test switch provided ^{4,5}
	1/32TRT One 32W TRT lamp	277 277V ³	GMF Single, slow-blow fuse; must specify voltage ^{3,4}
	1/42TRT One 42W TRT lamp	347 347V ³	ADEZ Advance® Mark X® electronic dimming ballast, 120V or 277V; minimum dimming level 5% ^{3,4}
	1/26DTT One 26W DTT lamp		DMHL LUTRON® Compact SE™ electronic dimming ballast, 120V or 277V; minimum dimming level 5% ^{3,4}
			BDP Ballast disconnect plug (meets codes that require in-fixture disconnect)
			S5 1.0 ballast factor Simply5™ system ^{4,6}
			S5HW Hardwire for Simply5™ system; replaces RELOC® wiring ^{4,6}
			WLP 35K lamp (shipped separately)

ADDITIONAL INFORMATION

For additional product information, visit www.lithonia.com.

Drawings are for dimensional detail only and may not represent actual mechanical configuration. Dimensions are shown in inches (centimeters) unless otherwise noted.

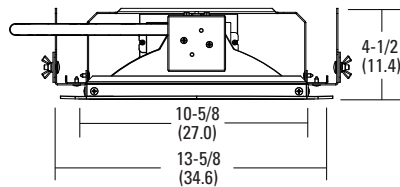

Notes

- 1 Not available with DMHL or WLP.
- 2 Electronic multi-volt ballast capable of operating any line voltage from 120-277V, 50 or 60Hz.
- 3 Wattage and voltage must be specified when ordering with GMF, ADEZ and DMHL.
- 4 Not available in 347V.
- 5 Not compatible with S5 option.
- 6 SIMPLY5™ includes 9" S5 MLC RELOC wiring system (shipped separately); available 120 or 277V only.

PRODUCT INFORMATION

LF8N

2-Lamp, Double Twin-Tube (DTT)



Intended Use
Ideal for a wide variety of low- to medium-height ceiling applications including commercial, retail and hospitality spaces where open, baffled, wallwash and lensed reflectors are required.

Construction
Heavy-gauge die-formed galvanized steel mounting frame with mechanical trim retention (yoke) ensures secure and flush reflector

mounting to ceiling. Vertically adjustable mounting brackets for use with 16-gauge flat barhangers (included), C channels or 1/2" steel conduit. Junction boxes equipped with two 3/4" and four 1/2" conduit knockouts with pryout slots and removable access doors.

Maximum ceiling thickness 1-1/2".

Electrical
Electronic ballast with end of life protection standard. Class P thermally protected ballast that protects against improper contact with insulation. Minimum starting temperature is 0°F/-18°C. Rated for #12 AWG conductor through-branch wiring. Minimum 90°C supply wire. Ground wire provided.

Listings
Fixtures are UL Listed for through-branch wiring, Non-IC recessed mounting, damp location, and to U.S. and Canadian safety standards.



ORDERING INFORMATION For shortest lead times, configure products using **bolded options**.

Example: LF8N 2/26DTT F802A MVOLT

Series	Lamp type	Reflector	Lens ¹	Voltage	Options
LF8N	2/18DTT	Choose reflector below.	CGL Clear glass lens	MVOLT ² 120 277 347 ³	ADEZ Advance® Mark X® electronic dimming ballast, 120V or 277V; minimum dimming level 5%
	2/26DTT	Housing and reflector may be ordered separately. Lamp types and maximum wattages are listed for each reflector.	T73 Tempered glass prismatic lens PCL Clear polycarbonate lens		DMHL Lutron® Compact SE™ electronic dimming ballast, 120V or 277V; minimum dimming level 5%
					EL Emergency battery pack with integral test switch ⁴ ELR Emergency battery pack with remote test switch ⁴ ELRHL2LP Emergency battery pack with remote test switch; operates two 26W (2,600 lumens average) ⁵ BDP Ballast disconnect plug meets codes that require in-fixture disconnect GMF Single slow-blow fuse; specify voltage RIF1 Radio interference filters LBH Less barhangers TRW White flange WLP 35K lamp (shipped separately)

Open reflector		Baffle with specular upper reflector		Wallwash with integral kicker		Glass lens with specular upper reflector	
F802	White ¹	F8B3	Black baffle ⁶	F8W1	White	F8LF1	White splay, clear lens ^{6,7}
F802A	Clear diffuse ¹	F8B3W	White baffle ⁶	F8W1A	Clear diffuse	F8LFB1	Black baffle, clear lens ^{6,7}
F802AZ	Clear semi-specular ¹			F8W1AZ	Clear semi-specular	F8L4	White splay, fresnel lens ^{6,7}
F802G	Gold diffuse ¹			F8W1G	Gold diffuse	F8LB4	Black baffle, fresnel lens ^{6,7}
F802GZ	Gold semi-specular ¹			F8W1GZ	Gold semi-specular	F8LF73	White splay, tempered prismatic lens ^{6,7}
F802PR	Pewter diffuse ¹			F8W1PR	Pewter diffuse	F8LFB73	Black baffle, tempered prismatic lens ^{6,7}
F802WTZ	Wheat semi-specular ¹			F8W1WTZ	Wheat semi-specular		

ADDITIONAL INFORMATION For additional product information, visit www.lithonia.com.

STANDARD PACKAGING
To order, use single master catalog number.
Example: (13) LF8N 2/26DTT F802A MVOLT
Fixtures ship as multiple components using optimized packaging. Example above ships as:
(Qty 13) LF8N 2/26DTT MVOLT (13 cartons of one housing)
(Qty 13) F802A (13 cartons of one reflector)

Drawings are for dimensional detail only and may not represent actual mechanical configuration. Dimensions are shown in inches (centimeters) unless otherwise noted.

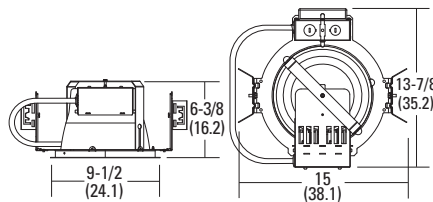

Notes

- 1 Damp lens available with F802 reflectors.
- 2 Electronic multi-volt ballast capable of operating any line voltage from 120-277V, 50 or 60Hz.
- 3 Not available with EL or ELR.
- 4 Ships standard for one-lamp operation. For two-lamp emergency operation, consult installation instructions or factory. Add 3" (7.6) to width and 4-1/2" (11.4) to length.
- 5 Not recommended for field installation.
- 6 White painted flange (TRW) standard.
- 7 Lensed reflectors are wet location listed.

Intended Use

Ideal for a wide variety of low- to medium-height ceiling applications including commercial, retail and hospitality spaces where open, baffled, wallwash and lensed reflectors are required.

Construction

Heavy-gauge die-formed galvanized steel mounting frame with mechanical trim retention (yoke) ensures

secure and flush reflector mounting to ceiling. Vertically adjustable mounting brackets for use with 16-gauge flat barhangers (included), C channels or 1/2" steel conduit. Junction boxes equipped with two 3/4" and four 1/2" conduit knockouts with pryout slots and removable access doors.

Maximum ceiling thickness 1-1/2".

Electrical

Electronic ballast with end of life protection standard. Class P thermally protected ballast that protects against improper contact with insulation. Minimum starting temperature is 0°F/-18°C. Rated for #12 AWG conductor through-branch wiring. Minimum 90°C supply wire. Ground wire provided.

Listings

Fixtures are UL Listed for through-branch wiring, Non-IC recessed mounting, damp location, and to U.S. and Canadian safety standards.

LF8N

2-Lamp, Triple-Tube (TRT)



ORDERING INFORMATION

For shortest lead times, configure products using **bolded options**.

Example: LF8N 2/26-42TRT F803A MVOLT

Series	Lamp type	Reflector	Lens ²	Voltage
LF8N	2/26-42TRT¹	Choose reflector below.	CGL Clear glass lens	MVOLT³
	2/26TRT	Housing and reflector may be ordered separately.	T73 Tempered glass prismatic lens	120
	2/32TRT	Lamp types and maximum wattages are listed for each reflector.	PCL Clear polycarbonate lens	277
	2/42TRT			347 ⁴

Options

ADEZ	Advance® Mark X® electronic dimming ballast, 120V or 277V; minimum dimming level 5%	BDP	Ballast disconnect plug meets codes that require in-fixture disconnect
DMHL	Lutron® Compact SE™ electronic dimming ballast, 120V or 277V; minimum dimming level 5%	GMF	Single slow-blow fuse; specify voltage
EL	Emergency battery pack with integral test switch ⁵	RIF1	Radio interference filters
ELR	Emergency battery pack with remote test switch ⁵	LBH	Less barhangers
ELRHL2-42	Emergency battery pack with remote test switch; operates two 42W CFL (2,800 lumens average) ⁶	TRW	White flange
ELRHL2LP	Emergency battery pack with remote test switch; operates two 26W (2,600 lumens average) or two 32W CFL (2,750 lumens average) ⁶	WLP	35K lamp (shipped separately)

Open reflector		Baffle with specular upper reflector		Wallwash with integral kicker		Glass lens with specular upper reflector	
F803	White ²	F8B4	Black baffle ⁷	F8W3	White	F8LT1	White splay, clear lens ^{7,8}
F803A	Clear diffuse ²	F8B4W	White baffle ⁷	F8W3A	Clear diffuse	F8LTB1	Black baffle, clear lens ^{7,8}
F803AZ	Clear semi-specular ²			F8W3AZ	Clear semi-specular	F8LT4	White splay, fresnel lens ^{7,8}
F803G	Gold diffuse ²			F8W3G	Gold diffuse	F8LTB4	Black baffle, fresnel lens ^{7,8}
F803GZ	Gold semi-specular ²			F8W3GZ	Gold semi-specular	F8LT73	White splay, tempered prismatic lens ^{7,8}
F803PR	Pewter diffuse ²			F8W3PR	Pewter diffuse	F8LTB73	Black baffle, tempered prismatic lens ^{7,8}
F803WTZ	Wheat semi-specular ²			F8W3WTZ	Wheat semi-specular		

ADDITIONAL INFORMATION

For additional product information, visit www.lithonia.com.

STANDARD PACKAGING
To order, use single master catalog number.
Example: (13) LF8N 2/26-42TRT F803A MVOLT
Fixtures ship as multiple components using optimized packaging. Example above ships as:
(Qty 13) LF8N 26-42TRT MVOLT (13 cartons of one housing)
(Qty 13) F803A (13 cartons of one reflector)

Drawings are for dimensional detail only and may not represent actual mechanical configuration. Dimensions are shown in inches (centimeters) unless otherwise noted.

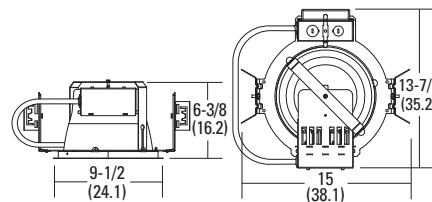

Notes

- 1 Not available with DMHL or WLP.
- 2 Damp lens available with F803 reflectors.
- 3 Electronic multi-volt ballast capable of operating any line voltage from 120-277V, 50 or 60Hz.
- 4 Not available EL or ELR.
- 5 Ships standard for one-lamp operation. For two-lamp emergency operation, consult installation instructions or factory. Add 3" (7.6) to width and 4-1/2" (11.4) to length.
- 6 Not recommended for field installation.
- 7 White painted flange (TRW) standard.
- 8 Lensed reflectors are wet location listed.

PRODUCT INFORMATION

LF8N

1-Lamp, Triple-Tube (TRT)



Intended Use

Ideal for a wide variety of low- to medium-height ceiling applications including commercial, retail and hospitality spaces where open, baffled, wallwash and lensed reflectors are required.

Construction

Heavy-gauge die-formed galvanized steel mounting frame with mechanical trim retention (yoke) ensures secure and flush reflector mounting to ceiling. Vertically adjustable mounting

brackets for use with 16-gauge flat barhangers (included), C channels or 1/2" steel conduit. Junction boxes equipped with two 3/4" and four 1/2" conduit knockouts with pryout slots and removable access doors.

Maximum ceiling thickness 1-1/2".

Electrical

Electronic ballast with end of life protection standard. Class P thermally protected ballast that protects against improper contact with

insulation. Minimum starting temperature is 0°F/-18°C. Rated for #12 AWG conductor through-branch wiring. Minimum 90° supply wire. Ground wire provided.

Listings

Fixtures are UL Listed for through-branch wiring, Non-IC recessed mounting, damp location, and to U.S. and Canadian safety standards.

ORDERING INFORMATION

For shortest lead times, configure products using **bolded options**.

Example: LF8N 1/26-42TRT F801A MVOLT

Series	Lamp type	Reflector	Lens ³	Voltage	Options
LF8N	1/26-42TRT¹	Choose reflector below.	CGL Clear glass lens	MVOLT²	ADEZ Advance® Mark X® electronic dimming ballast, 120V or 277V; minimum dimming level 5%
	1/26TRT	Housing and reflector may be ordered separately.	T73 Tempered glass prismatic lens	120	DMHL LUTRON® Compact SE™ electronic dimming ballast, 120V or 277V; minimum dimming level 5%
	1/32TRT	Lamp types and maximum wattages are listed for each reflector.	PCL Clear polycarbonate lens	277	EL Emergency battery pack with integral test switch ⁶
	1/42TRT			347 ⁵	ELR Emergency battery pack with remote test switch ⁶
	1/57TRT ²				ELRHL High lumen output emergency battery pack; remote test switch provided ⁷
					BDP Ballast disconnect plug meets codes that require in-fixture disconnect
					GMF Single slow-blow fuse; specify voltage
					RIF1 Radio interference filter
					LBH Less barhangers
					TRW White flange
					WLP 35K lamp (shipped separately)

Open reflector		Baffle with specular upper reflector		Wallwash with integral kicker		Glass lens with specular upper reflector	
F801	White ³	F8B5	Black baffle ⁸	F8W4	White	F8LS1	White splay, flat clear lens ^{8,9}
F801A	Clear diffuse ³	F8B5W	White baffle ⁸	F8W4A	Clear diffuse	F8LSB1	Black baffle, flat clear lens ^{8,9}
F801AZ	Clear semi-specular ³			F8W4AZ	Clear semi-specular	F8LS4	White splay, fresnel lens ^{8,9}
F801G	Gold diffuse ³			F8W4G	Gold diffuse	F8LSB4	Black baffle, fresnel lens ^{8,9}
F801GZ	Gold semi-specular ³			F8W4GZ	Gold semi-specular	F8LS73	White splay, tempered prismatic lens ^{8,9}
F801PR	Pewter diffuse ³			F8W4PR	Pewter diffuse	F8LSB73	Black baffle, tempered prismatic lens ^{8,9}
F801WTZ	Wheat semi-specular ³			F8W4WTZ	Wheat semi-specular		

ADDITIONAL INFORMATION

For additional product information, visit www.lithonia.com.

STANDARD PACKAGING

To order, use single master catalog number.

Example: (13) **LF8N 1/26-42TRT F801A MVOLT**

Fixtures ship as multiple components using optimized packaging. Example above ships as:

(Qty13) **LF8N 1/26-42TRT MVOLT** (13 cartons of one housing)

(Qty13) **F801A** (13 cartons of one reflector)

Drawings are for dimensional detail only and may not represent actual mechanical configuration. Dimensions are shown in inches (centimeters) unless otherwise noted.

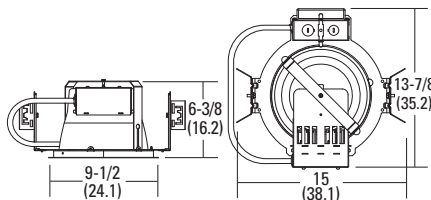

Notes

- Not available with DMHL or WLP.
- Not available with 347, DMHL, EL or ELR.
- Damp lens only available with F801 reflectors.
- Electronic multi-volt ballast capable of operating any line voltage from 120-277V, 50 or 60Hz.
- Not available with EL or ELR.
- Add 3" (7.6) to width and 4-1/2" (11.4) to length.
- Not recommended for field installation.
- White painted flange (TRW) standard.
- Lensed reflectors are wet location listed.

Intended Use

Ideal for a wide variety of low- to medium-height ceiling applications including commercial, retail and hospitality spaces where open, baffled, wallwash and lensed reflectors are required.

Construction

Heavy-gauge die-formed galvanized steel mounting frame. Vertically adjustable mounting brackets for use with 16-gauge flat barhangers (included), C channels or

1/2" steel conduit. Junction boxes equipped with two 3/4" and four 1/2" conduit knockouts with pryout slots and removable access doors.

Utilizes an extruded socket housing that attaches to the reflector via key hole mount, which provides superior heat dissipation and extended lamp life. Socket housing also adjusts to accommodate varying lamp lengths.

Maximum ceiling thickness 1-1/2".

Electrical

Electronic ballast with end of life protection standard. Class P thermally protected ballast that protects against improper contact with insulation. Minimum starting temperature is 0°F/-18°C. Rated for #12 AWG conductor through-branch wiring. Minimum 90°C supply wire. Ground wire provided.

Listings

Fixtures are UL Listed for through-branch wiring, Non-IC recessed mounting, damp location, and to U.S. and Canadian safety standards.

LP8FN

1-Lamp, Double Twin-Tube (DTT)
1-Lamp, Triple-Tube (TRT)



Example: LP8FN 26-42TRT 802A MVOLT

ORDERING INFORMATION For shortest lead times, configure products using **bolded options**.

Series	Lamp type	Reflector	Lens ³	Voltage	Options
LP8FN	18DTT	Choose reflector below.	CGL Clear glass lens	MVOLT ⁴ 120 277 347 ⁵	ADEZ Advance® Mark X® electronic dimming ballast, 120V or 277V; minimum dimming level 5%
	26DTT	Housing and reflector may be ordered separately.	T73 Tempered glass prismatic lens		DMHL LUTRON® Compact SE™ electronic dimming ballast, 120V or 277V; minimum dimming level 5%
	18TRT	Lamp types and maximum wattages are listed for each reflector	PCL Clear polycarbonate lens		EL Emergency battery pack with integral test switch ⁶
	26-42TRT		ELR Emergency battery pack with remote test switch ⁶		
	26TRT		ELRHL High lumen output emergency battery pack; remote test switch provided ⁷		
	32TRT		BDP Ballast disconnect plug meets codes that require in-fixture disconnect		
	42TRT		GMF Single slow-blow fuse; specify voltage		
57TRT ²	RIF1 Radio interference filter				
				LBH Less barhangers	
				TRW White flange	
				WLP 35K Lamp (shipped separately)	

Open reflector		Baffle with specular upper reflector		Wallwash with integral kicker		Glass lens	
802	White ³	8B3	Black baffle ⁸	8W1	White	8LF1	White splay, clear lens ^{8,9}
802A	Clear diffuse ³	8B3W	White baffle ⁸	8W1A	Clear diffuse	8LFB1	Black baffle, clear lens ^{8,9}
802AZ	Clear semi-specular ³			8W1AZ	Clear semi-specular	8L4	White splay, fresnel lens ^{8,9}
802G	Gold diffuse ³			8W1G	Gold diffuse	8LB4	Black baffle, fresnel lens ^{8,9}
802GZ	Gold semi-specular ³			8W1GZ	Gold semi-specular	8LF73	White splay, tempered prismatic lens ^{8,9}
802PR	Pewter diffuse ³			8W1PR	Pewter diffuse	8LFB73	Black baffle, tempered prismatic lens ^{8,9}
802WTZ	Wheat semi-specular ³			8W1WTZ	Wheat semi-specular		

ADDITIONAL INFORMATION For additional product information, visit www.lithonia.com.

STANDARD PACKAGING
To order, use single master catalog number.
Example: (13) LP8FN 26-42TRT 802A MVOLT
Fixtures ship as multiple components using optimized packaging. Example above ships as:
(Qty 13) LP8FN 26-42TRT MVOLT (13 cartons of one housing)
(Qty 13) 802A (13 cartons of one reflector)

Drawings are for dimensional detail only and may not represent actual mechanical configuration. Dimensions are shown in inches (centimeters) unless otherwise noted.

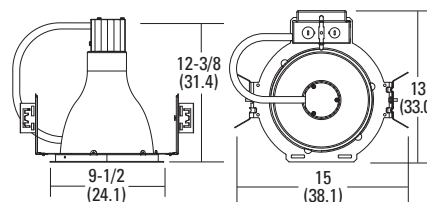

Notes

- 1 Not available with DMHL or WLP.
- 2 Not available with 347V, DMHL, EL or ELR.
- 3 Damp lens available with 802 reflectors.
- 4 Electronic multi-volt ballast capable of operating any line voltage from 120-277V, 50 or 60Hz.
- 5 Not available with EL or ELR.
- 6 Add 3" (7.6) to width and 4-1/2" (11.4) to length.
- 7 Not recommended for field installation.
- 8 White painted flange (TRW) standard.
- 9 Lensed reflectors are wet location listed.

PRODUCT INFORMATION

LF6N

2-Lamp, Double Twin-Tube (DTT)



Intended Use
Ideal for a wide variety of low- to medium-height ceiling applications including commercial, retail and hospitality spaces where open, baffled, wallwash and lensed reflectors are required.

Construction
Heavy-gauge die-formed galvanized steel mounting frame with mechanical trim

retention (yoke) ensures secure and flush reflector mounting to ceiling. Vertically adjustable mounting brackets for use with 16-gauge flat barhangers (included), C channels or 1/2" steel conduit. Junction boxes equipped with two 3/4" and four 1/2" conduit knockouts with pryout slots and removable access doors.

Maximum ceiling thickness 1-1/2".

Electrical
Electronic ballast with end of life protection standard. Class P thermally protected ballast that protects against improper contact with insulation. Minimum starting temperature is 0°F/-18°C. Rated for #12 AWG conductor through-branch wiring.

Minimum 90°C supply wire. Ground wire provided.

Listings
Fixtures are UL Listed for through-branch wiring, Non-IC recessed mounting, damp location, and to U.S. and Canadian safety standards.



Example: LF6N 2/26DTT F602A MVOLT

ORDERING INFORMATION For shortest lead times, configure products using **bolded options**.

Series	Lamp type	Reflector	Lens ²	Voltage	Options
LF6N	2/13DTT ¹	Choose reflector below. Housing and reflector may be ordered separately. Lamp types and maximum wattages are listed for each reflector.	CGL Clear glass lens T73 Tempered glass prismatic lens PCL Clear polycarbonate lens	MVOLT ³ 120 277 347 ⁴	ADEZ Advance® Mark X® electronic dimming ballast, 120V or 277V; minimum dimming level 5%
	2/18DTT				DMHL LUTRON® Compact SE™ electronic dimming ballast, 120V or 277V; minimum dimming level 5%
	2/26DTT				EL Emergency battery pack with integral test switch ⁵ ELR Emergency battery pack with remote test switch ⁵ ELRHL2LP Emergency battery pack with remote test switch; operates two 26W (2,600 lumens average) ⁶ BDP Ballast disconnect plug meets codes that require in-fixture disconnect GMF Single slow-blow fuse; specify voltage RIF1 Radio interference filter LBH Less barhangers TRW White flange WLP 35K lamp (shipped separately)

Open reflector

- F602 White²
- F602A** Clear diffuse²
- F602AZ** Clear semi-specular²
- F602G Gold diffuse²
- F602GZ Gold semi-specular²
- F602PR Pewter diffuse²
- F602WTZ Wheat semi-specular²



2/26DTT

Baffle with specular upper reflector

- F6B3** Black baffle⁷
- F6B3W** White baffle⁷



2/26DTT

Wallwash with integral kicker

- F6W1 White
- F6W1A** Clear diffuse
- F6W1AZ** Clear semi-specular
- F6W1G Gold diffuse
- F6W1GZ Gold semi-specular
- F6W1PR Pewter diffuse
- F6W1WTZ Wheat semi-specular



2/26DTT

Open cone

- F6C3BLZ Black semi-specular



2/26DTT

Glass lens (wet location)

- F6LF3 White splay, white lens^{7,8}
- F6LFB3 Black baffle, white lens^{7,8}
- F6L4** White splay, fresnel lens^{7,8}
- F6LB4** Black baffle, fresnel lens^{7,8}
- F6LF73 White splay, tempered prismatic lens^{7,8}
- F6LFB73 Black baffle, tempered prismatic lens^{7,8}



2/26DTT

Drop glass lens (wet location)

- F6LD3** White splay, drop opal lens^{7,8}
- F6LDB3** Black baffle, drop opal lens^{7,8}



2/26DTT

ADDITIONAL INFORMATION For additional product information, visit www.lithonia.com.

STANDARD PACKAGING

To order, use single master catalog number.

Example: (13) **LF6N 2/26DTT F602A MVOLT**

Fixtures ship as multiple components using optimized packaging.

Example above ships as:

(Qty 13) **LF6N 2/26DTT MVOLT** (13 cartons of one housing)

(Qty 13) **F602A** (13 cartons of one reflector)

Drawings are for dimensional detail only and may not represent actual mechanical configuration. Dimensions are shown in inches (centimeters) unless otherwise noted.

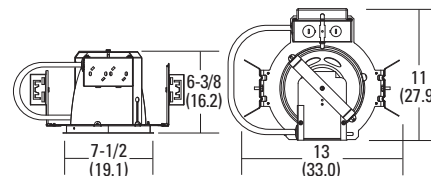

Notes

- Not available with ADEZ or DMHL.
- Damp lens only available with F602 reflector.
- Electronic multi-volt ballast capable of operating any line voltage from 120-277V, 50 or 60Hz.
- Not available with EL or ELR.
- Ships standard for one-lamp operation. For two-lamp operation, consult installation instructions or contact factory. Add 3" (7.6) to width and 4-1/2" (11.4) to length.
- Not recommended for field installation.
- White painted flange (TRW) standard.
- Lensed reflectors are wet location listed.

Intended Use

Ideal for a wide variety of low- to medium-height ceiling applications including commercial, retail and hospitality spaces where open, baffled, wallwash and lensed reflectors are required.

Construction

Heavy-gauge die-formed galvanized steel mounting frame with mechanical trim

retention (yoke) ensures secure and flush reflector mounting to ceiling. Vertically adjustable mounting brackets for use with 16-gauge flat barhangers (included), C channels or 1/2" steel conduit. Junction boxes equipped with two 3/4" and four 1/2" conduit knockouts with pryout slots and removable access doors.

Maximum ceiling thickness 1-1/2".

Electrical

Electronic ballast with end of life protection standard. Class P thermally protected ballast that protects against improper contact with insulation. Minimum starting temperature is 0°F/-18°C. Rated for #12 AWG conductor through-branch wiring.

Minimum 90°C supply wire. Ground wire provided.

Listings

Fixtures are UL Listed for through-branch wiring, Non-IC recessed mounting, damp location, and to U.S. and Canadian safety standards.

LF6N

1- Lamp, Triple-Tube (TRT)



ORDERING INFORMATION

For shortest lead times, configure products using **bolded options**.

Example: LF6N 1/26-42TRT F601A MVOLT

Series	Lamp type	Reflector	Lens ²	Voltage	Options
LF6N	1/26-42TRT¹	Choose reflector below.	CGL Clear glass lens	MVOLT³	ADEZ Advance® Mark X® electronic dimming ballast, 120V or 277V; minimum dimming level 5%
	1/26TRT	Housing and reflector may be ordered separately.	T73 Tempered glass prismatic lens	120	DMHL LUTRON® Compact SE™ electronic dimming ballast, 120V or 277V; minimum dimming level 5%
	1/32TRT	Lamp types and maximum wattages are listed for each reflector.	PCL Clear polycarbonate lens	277	EL Emergency battery pack with integral test switch ⁵
	1/42TRT			347 ⁴	ELR Emergency battery pack with remote test switch ⁵
					ELRHL High lumen output emergency battery pack; remote switch test switch provided ⁶
					BDP Ballast disconnect plug meets codes that require in-fixture disconnect
					GMF Single slow-blow fuse; specify voltage
					RIF1 Radio interference filter
					LBH Less barhangers
					TRW White flange
					WLP 35K lamp (shipped separately)

Open reflector		Baffle with specular upper reflector		Wallwash with integral kicker		Glass lens (wet location)	
F601	White ²	F6B5	Black baffle ⁷	F6W4	White	F6LS1	White splay, clear lens ^{7,8}
F601A	Clear diffuse ²	F6B5W	White baffle ⁷	F6W4A	Clear diffuse	F6LSB1	Black baffle, clear lens ^{7,8}
F601AZ	Clear semi-specular ²			F6W4AZ	Clear semi-specular	F6LS4	White splay, fresnel lens ^{7,8}
F601G	Gold diffuse ²			F6W4G	Gold diffuse	F6LSB4	Black baffle, fresnel lens ^{7,8}
F601GZ	Gold semi-specular ²			F6W4GZ	Gold semi-specular	F6LS73	White splay, tempered prismatic lens ^{7,8}
F601PR	Pewter diffuse ²			F6W4PR	Pewter diffuse	F6LSB73	Black baffle, tempered prismatic lens ^{7,8}
F601WTZ	Wheat semi-specular ²			F6W4WTZ	Wheat semi-specular		

ADDITIONAL INFORMATION

For additional product information, visit www.lithonia.com.

STANDARD PACKAGING
To order, use single master catalog number.
Example: (13) LF6N 1/26-42TRT F601A MVOLT
Fixtures ship as multiple components using optimized packaging. Example above ships as:
(Qty 13) LF6N 1/26-42TRT MVOLT (13 cartons of one housing)
(Qty13) F601A (13 cartons of one reflector)

Drawings are for dimensional detail only and may not represent actual mechanical configuration. Dimensions are shown in inches (centimeters) unless otherwise noted.

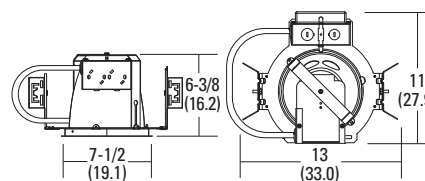

Notes

- Not available with DMHL or WLP.
- Damp lens only available with F601 reflector.
- Electronic multi-volt ballast capable of operating any line voltage from 120-277V, 50 or 60Hz.
- Not available with EL or ELR.
- Add 3" (7.6) to width and 4-1/2" (11.4) to length.
- Not recommended for field installation.
- White painted flange (TRW) standard.
- Lensed reflectors are wet location listed.

PRODUCT INFORMATION

LIF6

2-Lamp, Double Twin-Tube (DTT) IC Rated



Intended Use
New construction applications requiring high-performance horizontal reflectors using compact fluorescent lamps.

Construction
Mechanical: Pre-painted, rugged steel frame-in with adjustable integral yoke to retain optical system. Galvanized bar hangers span up to 24" o.c. and feature built-in nailers and T-bar clips. Galvanized steel junction box with removable access door,

four Romex knockouts, two 3/4" and four 1/2" nominal conduit knockouts with pryout slots.

Maximum ceiling thickness 1-1/2".

Electrical
Electronic ballast with end of life protection standard. Class P thermally protected ballast that protects against improper contact with insulation. Minimum starting temperature is 0°F/-18°C.

Rated for #12 AWG conductor through-branch wiring. Minimum 90°C supply wire. Ground wire provided.

Listings
Fixtures are UL Listed for through-branch wiring, IC recessed mounting, damp location, and to U.S. and Canadian safety standards.

ORDERING INFORMATION For shortest lead times, configure products using **bolded options**.

Example: LIF6 2/13DDT F602A MVOLT

Series	Lamp type	Reflector	Voltage	Options
LIF6	2/13DDT	Choose reflector below. Housing and reflector may be ordered separately. Lamp types and maximum wattages are listed for each reflector.	MVOLT¹	BDP Ballast disconnect plug meets codes that require in-fixture disconnect PHC Poke-home wire connectors factory installed push-in terminals AT Aluminum tape seals housing to minimize air flow through rough-in; complies with WSEC and certified per ASTM E283 requirements GMF Single slow-blow fuse; specify voltage RIF1 Radio interference filter TRW White flange WLP 35K lamp (shipped separately)

Open reflector	Open cone	Baffle with specular upper reflector	Wallwash with intgral kicker	Glass lens (wet location)
F602 White F602A Clear diffuse F602AZ Clear semi-specular F602G Gold diffuse F602GZ Gold semi-specular F602PR Pewter diffuse F602WTZ Wheat semi-specular	F6C3BLZ Black semi-specular open cone	F6B3 Black baffle ² F6B3W White baffle ²	F6W1 White F6W1A Clear diffuse F6W1AZ Clear semi-specular F6W1G Gold diffuse F6W1GZ Gold semi-specular F6W1PR Pewter diffuse F6W1WTZ Wheat semi-specular	F6LF3 White splay, white lens ^{2,3} F6LFB3 Black baffle, white lens ^{2,3} F6L4 White splay, fresnel lens ^{2,3} F6LB4 Black baffle, fresnel lens ^{2,3} F6LF73 White splay, tempered prismatic lens ^{2,3} F6LFB73 Black baffle, tempered prismatic lens ^{2,3}

ADDITIONAL INFORMATION For additional product information, visit www.lithonia.com.

STANDARD PACKAGING
To order, use single master catalog number.
Example: (13) LIF6 2/13DDT F602A MVOLT
Fixtures ship as multiple components using optimized packaging. Example above ships as: (Qty 13) LIF6 2/13DDT MVOLT (13 cartons of one housing) (Qty 13) F602A (13 cartons of one reflector)

Drawings are for dimensional detail only and may not represent actual mechanical configuration. Dimensions are shown in inches (centimeters) unless otherwise noted.

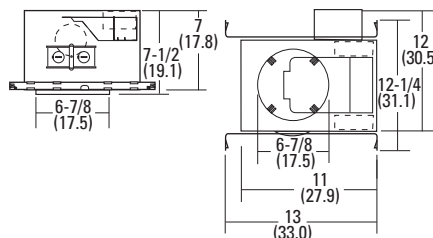

- Notes**
- 1 Electronic multi-volt ballast capable of operating any line voltage from 120-277V, 50 or 60Hz.
 - 2 White painted flange (TRW) standard.
 - 3 Lensed reflectors are wet location listed.

Intended Use

Ideal for a wide variety of low- to medium-height ceiling applications including commercial, retail and hospitality spaces where open, baffled, wallwash and lensed reflectors are required.

Construction

Heavy-gauge die-formed galvanized steel mounting frame. Vertically adjustable mounting brackets for use with 16-gauge flat barhang-

ers (included), C channels or 1/2" steel conduit. Junction boxes equipped with two 3/4" and four 1/2" conduit knockouts with pryout slots and removable access doors.

Utilizes an extruded socket housing that attaches to the reflector via key hole mount, which provides superior heat dissipation and extended lamp life. Socket housing also adjusts to accommodate varying lamp lengths.

Maximum ceiling thickness 1-1/2".

Electrical

Electronic ballast with end of life protection standard. Class P thermally protected ballast that protects against improper contact with insulation. Minimum starting temperature is 0°F/-18°C. Rated for #12 AWG conductor through-branch wiring. Minimum 90°C supply wire. Ground wire provided.

Listings

Fixtures are UL Listed for through-branch wiring, Non-IC recessed mounting, damp location, and to U.S. and Canadian safety standards.

LP6FN

1-Lamp, Double Twin-Tube (DTT)
1-Lamp, Triple-Tube (TRT)



ORDERING INFORMATION

For shortest lead times, configure products using **bolded options**.

Example: LP6FN 26-42TRT 609A MVOLT

Series	Lamp type	Reflector	Lens ³	Voltage	Options
LP6FN	13DTT ¹	26-42TRT²	Choose reflector below.	MVOLT⁴	ADEZ Advance® Mark X® electronic dimming ballast, 120V or 277V; minimum dimming level 5%
	18DTT	18TRT	Housing and reflector may be ordered separately.		DMHL LUTRON® Compact SE™ electronic dimming ballast, 120V or 277V; minimum dimming level 5%
	26DTT	26TRT	Lamp types and maximum wattages are listed for each reflector.		EL Emergency battery pack with integral test switch ⁶
	13TRT ¹	32TRT			ELR Emergency battery pack with remote test switch ⁶
	18DTT/TRT ²	42TRT			ELRHL High lumen output emergency battery pack; remote test switch provided ⁷
			CGL Clear glass lens	120	BDP Ballast disconnect plug meets codes that require in-fixture disconnect
			T73 Tempered glass prismatic lens	277	GMF Single slow-blow fuse; specify voltage
			PCL Clear polycarbonate lens	347 ⁵	RIF1 Radio interference filter
					LBH Less barhangers
					TRW White flange
					WLP 35K lamp (shipped separately)

Open reflector	Baffle with diffuse upper reflector	Wallwash with integral kicker	Glass lens (wet location)
609 White ³	6B9 Black baffle ⁸	6W9 White	6LRF1 White splay, clear lens ^{8,9}
609A Clear diffuse ³	6B9W White baffle ⁸	6W9A Clear diffuse	6LRFB1 Black baffle, clear lens ^{8,9}
609AZ Clear semi-specular ³		6W9AZ Clear semi-specular	6LR4 White splay, fresnel lens ^{8,9}
609G Gold diffuse ³		6W9G Gold diffuse	6LRB4 Black baffle, fresnel lens ^{8,9}
609GZ Gold semi-specular ³		6W9GZ Gold semi-specular	6LRF73 White splay, tempered prismatic lens ^{8,9}
609PR Pewter diffuse ³		6W9PR Pewter diffuse	6LRFB73 Black baffle, tempered prismatic lens ^{8,9}
609WTZ Wheat semi-specular ³		6W9WTZ Wheat semi-specular	

ADDITIONAL INFORMATION

For additional product information, visit www.lithonia.com.

STANDARD PACKAGING
To order, use single master catalog number.
Example: (13) LP6FN 26-42TRT 609A MVOLT
Fixtures ship as multiple components using optimized packaging. Example above ships as:
(Qty 13) LP6FN 26-42TRT MVOLT (13 cartons of one housing)
(Qty 13) 609A (13 cartons of one reflector)

Drawings are for dimensional detail only and may not represent actual mechanical configuration. Dimensions are shown in inches (centimeters) unless otherwise noted.

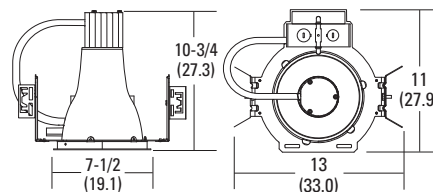

Notes

- Not available with ADEZ or DMHL.
- Not available with WLP.
- Damp lens available with 609 reflectors.
- Electronic multi-volt ballast capable of operating any line voltage from 120-277V, 50 or 60Hz.
- Not available with EL or ELR.
- Add 3" (7.6) to width and 4-1/2" (11.4) to length.
- Not recommended for field installation.
- White painted flange (TRW) standard.
- Lensed reflectors are wet location listed.

PRODUCT INFORMATION

LP8HN



Intended Use
New construction applications requiring high-performance vertical reflectors using HID lamps.

Construction
Heavy-gauge die-formed galvanized steel mounting frame. Vertically adjustable mounting brackets for use with 16-gauge flat barhangers (included), C channels or 1/2" steel conduit. Junction boxes equipped with two

3/4" and four 1/2" conduit knockouts with pryout slots and removable access doors.
Utilizes an extruded socket housing that attaches to the reflector via key hole mount, which provides superior heat dissipation and extended lamp life. Socket housing also adjusts to accommodate varying lamp lengths.
Maximum ceiling thickness 1-1/2".

Electrical
Frame-ins have medium base (ED-17) safety sockets standard rated for metal halide lamps. 347V electromagnetic ballast is encased and potted. 120/277V electronic ballast is standard for 50M, 70M and 100M.
Thermally protected against improper contact with insulation and approved for through-branch circuit wiring.

Rated for #12 AWG conductor through-branch wiring. Minimum 90°C supply wire. Ground wire provided.
Listings
Fixtures are UL Listed for through-branch wiring, Non-IC recessed mounting, damp location, and to U.S. and Canadian safety standards.



ORDERING INFORMATION For shortest lead times, configure products using **bolded options**.

Example: LP8HN 50M 802 120/277

Series	Lamp type	Reflector	Lens ²	Voltage	Options
LP8HN	Metal halide	Choose reflector below.	CGL Clear glass lens	120/277	SF Single fuse; must specify voltage
	50M 50W MP50/C/U	Housing and reflector may be ordered separately.	T73 Tempered glass prismatic lens	120	LBH Less barhangers
	70M 70W MP70/C/U	Lamp types and maximum wattages are listed for each reflector.		277	TRW White flange
	100M 100W MP100/C/U			347 ³	WLP Lamp (shipped separately)

Open reflector		Baffle with specular upper reflector		Wallwash with integral kicker		Glass lens with specular upper reflector	
802	White ²	8B3	Black baffle ⁵	8W1	White	8LF1	White splay, clear lens ^{4,5}
802A	Clear diffuse ²	8B3W	White baffle ⁵	8W1A	Clear diffuse	8LFB1	Black baffle, clear lens ^{4,5}
802AZ	Clear semi-specular ²			8W1AZ	Clear semi-specular	8L4	White splay, fresnel lens ^{4,5}
802G	Gold diffuse ²			8W1G	Gold diffuse	8LB4	Black baffle, fresnel lens ^{4,5}
802GZ	Gold semi-specular ²			8W1GZ	Gold semi-specular	8LF73	White splay, tempered prismatic lens ^{4,5}
802PR	Pewter diffuse ²			8W1PR	Pewter diffuse	8LFB73	Black baffle, tempered prismatic lens ^{4,5}
802WTZ	Wheat semi-specular ²			8W1WTZ	Wheat semi-specular		

ADDITIONAL INFORMATION For additional product information, visit www.lithonia.com.

STANDARD PACKAGING
To order, use single master catalog number.
Example: (12) LP8HN 50M 802 120/277
Fixtures ship as multiple components using optimized packaging. Example above ships as:
(Qty 12) LP8HN 50M 120/277 (12 cartons of one housing)
(Qty 12) 802 (12 cartons of one reflector)

Drawings are for dimensional detail only and may not represent actual mechanical configuration. Dimensions are shown in inches (centimeters) unless otherwise noted.

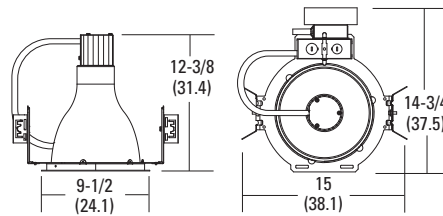

Notes

- 1 Ceramic arc tube consistent-color lamp. PHILIPS MASTERColor[®] or GE ConstantColor[®].
- 2 Damp lens available with 802 reflectors.
- 3 347V ballast only available with encased and potted electromagnetic ballast.
- 4 Lensed reflectors are wet location listed.
- 5 White painted flange standard.

Intended Use

New construction applications requiring high-performance vertical reflectors using HID lamps.

Construction

Heavy-gauge die-formed galvanized steel mounting frame. Vertically adjustable mounting brackets for use with 16-gauge flat barhangers (included), C channels or 1/2" steel conduit. Junction boxes equipped with two 3/4" and four 1/2" conduit

knockouts with pryout slots and removable access doors.

Utilizes an extruded socket housing that attaches to the reflector via key hole mount, which provides superior heat dissipation and extended lamp life. Socket housing also adjusts to accommodate varying lamp lengths.

Maximum ceiling thickness 1-1/2".

Electrical

Frame-ins have medium base sockets standard rated for

metal halide PAR lamps. 347V electromagnetic ballast is encased and potted. 120/277V electronic ballast is standard for 70M and 100M using PAR30, PAR38 and ceramic metal halide lamps.

Thermally protected against improper contact with insulation and approved for through-branch circuit wiring.

Rated for #12 AWG conductor through-branch wiring. Minimum 90°C supply wire. Ground wire provided.

Listings

Fixtures are UL Listed for through-branch wiring, Non-IC recessed mounting, damp location, and to U.S. and Canadian safety standards.

LP8HN
PAR



ORDERING INFORMATION

For shortest lead times, configure products using **bolded options**.

Example: LP8HN PAR 100M 802A 120/277

Series	Lamp type	Reflector	Lens ¹	Voltage	Options
LP8HN PAR	Metal halide	Color-corrected metal halide	Choose reflector below.	CGL Clear glass lens	SF Single fuse; must specify voltage
	70M 70W PAR38	70MHC 70W PAR30 or PAR38	Housing and reflector may be ordered separately.	T73 Tempered glass prismatic lens	LBH Less barhangers
	100M 100W PAR38	100MHC 100W PAR30 or PAR38	Lamp types and maximum wattages are listed for each reflector.		LPSP P30 PAR30 spot lamp (shipped separately)
					LPSP P38 PAR38 spot lamp (shipped separately)
					LPFL P30 PAR30 flood lamp (shipped separately)
					LPFL P38 PAR38 flood lamp (shipped separately)
					LPWFL P38 PAR38 wide flood lamp (shipped separately)

Open reflector	Baffle with specular upper reflector	Wallwash with integral kicker	Glass lens with specular upper reflector
802 White ¹	8B3 Black baffle ⁴	8W1 White	8LF1 White splay, clear lens ^{3,4}
802A Clear diffuse ¹	8B3W White baffle ⁴	8W1A Clear diffuse	8LFB1 Black baffle, clear lens ^{3,4}
802AZ Clear semi-specular ¹		8W1AZ Clear semi-specular	8L4 White splay, fresnel lens ^{3,4}
802G Gold diffuse ¹		8W1G Gold diffuse	8LB4 Black baffle, fresnel lens ^{3,4}
802GZ Gold semi-specular ¹		8W1GZ Gold semi-specular	8LF73 White splay, tempered prismatic lens ^{3,4}
802PR Pewter diffuse ¹		8W1PR Pewter diffuse	8LFB73 Black baffle, tempered prismatic lens ^{3,4}
802WTZ Wheat semi-specular ¹		8W1WTZ Wheat semi-specular	

ADDITIONAL INFORMATION

For additional product information, visit www.lithonia.com.

STANDARD PACKAGING
To order, use single master catalog number.
Example: (12) LP8HN PAR 100M 802A 120/277
Fixtures ship as multiple components using optimized packaging. Example above ships as:
(Qty 12) LP8HN PAR 100M 120/277 (12 cartons of one housing)
(Qty 12) 802A (12 cartons of one reflector)

Drawings are for dimensional detail only and may not represent actual mechanical configuration. Dimensions are shown in inches (centimeters) unless otherwise noted.

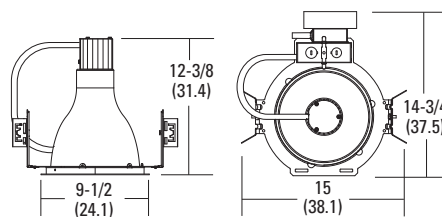

Notes

- Damp lens available with 802 reflectors.
- 347V ballast only available with encased and potted electromagnetic ballast.
- Lensed reflectors are wet location listed.
- White painted flange standard.

PRODUCT INFORMATION

LP6HN



Intended Use
New construction applications requiring high-performance vertical reflectors using HID lamps.

Construction
Heavy-gauge die-formed galvanized steel mounting frame. Vertically adjustable mounting brackets for use with 16-gauge flat barhangers (included), C channels or 1/2" steel conduit. Junction boxes equipped with two 3/4" and four 1/2" conduit

knockouts with pryout slots and removable access doors.

Utilizes an extruded socket housing that attaches to the reflector via key hole mount, which provides superior heat dissipation and extended lamp life. Socket housing also adjusts to accommodate varying lamp lengths.

Maximum ceiling thickness 1-1/2".

Electrical
Frame-ins have medium base (ED-17) safety sockets standard rated for metal halide lamps. Ballast is encased and potted, electromagnetic for 347V. For 120/277V, electronic is standard for 50M, 70M and 100M.

Thermally protected against improper contact with insulation and approved for through-branch circuit wiring.

Rated for #12 AWG conductor through-branch wiring. Minimum 90°C supply wire. Ground wire protected.

Listings
Fixtures are UL Listed for through-branch wiring, Non-IC recessed mounting, damp location, and to U.S. and Canadian safety standards.



ORDERING INFORMATION For shortest lead times, configure products using **bolded options**.

Example: LP6HN 50M 609A 120/277

Series	Lamp type	Reflector	Lens ²	Voltage	Options
LP6HN	Metal halide	Choose reflector below. Housing and reflector may be ordered separately. Lamp types and maximum wattages are listed for each reflector.	CGL Clear glass lens T73 Tempered glass prismatic lens	120/277 120 277 347 ³	SF Single fuse; specify voltage LBH Less barhangers TRW White flange WLP Lamp (shipped separately)
	Color-corrected metal halide ¹				
	50M 50W MP50/C/U				
	70M 70W MP70/C/U				
	100M 100W MP100/C/U				

Open reflector		Baffle with diffuse upper reflector		Wallwash with integral kicker		Glass lens (wet location)	
609	White ²	6B9	Black baffle ⁵	6W9	White	6LRF1	White splay, clear lens ^{4,5}
609A	Clear diffuse ²	6B9W	White baffle ⁵	6W9A	Clear diffuse	6LRFB1	Black baffle, clear lens ^{4,5}
609AZ	Clear semi-specular ²			6W9AZ	Clear semi-specular	6LR4	White splay, fresnel lens ^{4,5}
609G	Gold diffuse ²			6W9G	Gold diffuse	6LRB4	Black baffle, fresnel lens ^{4,5}
609GZ	Gold semi-specular ²			6W9GZ	Gold semi-specular	6LRF73	White splay, tempered prismatic lens ^{4,5}
609PR	Pewter diffuse ²			6W9PR	Pewter diffuse	6LRFB73	Black baffle, tempered prismatic lens ^{4,5}
609WTZ	Wheat semi-specular ²			6W9WTZ	Wheat semi-specular		
	100M 100MPC		100M 100MPC		100M 100MPC		100M 100MPC

ADDITIONAL INFORMATION For additional product information, visit www.lithonia.com.

STANDARD PACKAGING
To order, use single master catalog number.
Example: (12) LP6HN 50M 609A 120/277
Fixtures ship as multiple components using optimized packaging. Example above ships as:
(Qty 12) LP6HN 50M 120/277 (12 cartons of one housing)
(Qty 12) 609A (12 cartons of one reflector)

Drawings are for dimensional detail only and may not represent actual mechanical configuration. Dimensions are shown in inches (centimeters) unless otherwise noted.

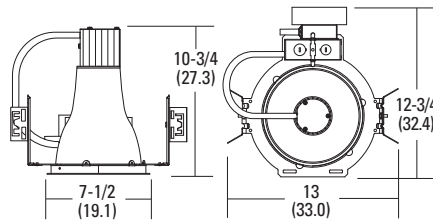

Notes

- 1 Ceramic arc tube consistent-color lamp. PHILIPS MASTERColor® or GE ConstantColor®.
- 2 Damp lens available with 609 reflectors.
- 3 347V ballast only available with encased and potted electromagnetic ballast.
- 4 Lensed reflectors are wet location listed.
- 5 White painted flange standard.

Intended Use

New construction applications requiring high-performance vertical reflectors using HID lamps.

Construction

Heavy-gauge die-formed galvanized steel mounting frame. Vertically adjustable mounting brackets for use with 16-gauge flat barhangers (included), C channels or 1/2" steel conduit. Junction boxes equipped with two

3/4" and four 1/2" conduit knockouts with pryout slots and removable access doors.

Utilizes an extruded socket housing that attaches to the reflector via key hole mount, which provides superior heat dissipation and extended lamp life. Socket housing also adjusts to accommodate varying lamp lengths.

Maximum ceiling thickness 1-1/2".

Electrical

Frame-ins have safety sockets standard rated for metal halide PAR lamps. 347V electromagnetic ballast is encased and potted. 120/277V electronic ballast is standard for 70M and 100M using PAR30, PAR38 and ceramic metal halide lamps.

Thermally protected against improper contact with

insulation and approved for through-branch circuit wiring.

Rated for #12 AWG conductor through-branch wiring. Minimum 90°C supply wire. Ground wire protected.

Listings

Fixtures are UL Listed for through-branch wiring, Non-IC recessed mounting, damp location, and to U.S. and Canadian safety standards.

LP6HN
PAR



ORDERING INFORMATION

For shortest lead times, configure products using **bolded options**.

Example: LP6HN PAR 100M 609A 120/277

Series	Lamp type	Reflector	Lens ¹	Voltage	Options
LP6HN PAR	Metal halide	Color corrected metal halide	Choose reflector below.	120/277	SF Single fuse; must specify voltage
	70M 70W PAR38	70MHC 70W PAR30 or PAR38	Housing and reflector may be ordered separately.	120	LPSP P30 PAR30 spot lamp (shipped separately)
	100M 100W PAR38	100MHC 100W PAR30 or PAR38	Lamp types and maximum wattages are listed for each reflector.	277	LPSP P38 PAR38 spot lamp (shipped separately)
				347 ²	LPFL P30 PAR30 flood lamp (shipped separately)
					LPFL P38 PAR38 flood lamp (shipped separately)
					LPWFL P38 PAR38 wide flood lamp (shipped separately)
					TRW White flange
					LBH Less barhangers

Open reflector	Baffle with diffuse upper reflector	Wallwash with integral kicker	Glass lens (wet location)
609 White ¹	6B9 Black baffle ⁴	6W9 White	6LRF1 White splay, clear lens ^{3,4}
609A Clear diffuse ¹	6B9W White baffle ⁴	6W9A Clear diffuse	6LRFB1 Black baffle, clear lens ^{3,4}
609AZ Clear semi-specular ¹		6W9AZ Clear semi-specular	6LR4 White splay, fresnel lens ^{3,4}
609G Gold diffuse ¹		6W9G Gold diffuse	6LRB4 Black baffle, fresnel lens ^{3,4}
609GZ Gold semi-specular ¹		6W9GZ Gold semi-specular	6LRF73 White splay, tempered prismatic lens ^{3,4}
609PR Pewter diffuse ¹		6W9PR Pewter diffuse	6LRF73 Black baffle, tempered prismatic lens ^{3,4}
609WTZ Wheat semi-specular ¹		6W9WTZ Wheat semi-specular	

ADDITIONAL INFORMATION

For additional product information, visit www.lithonia.com.

STANDARD PACKAGING
To order, use single master catalog number.
Example: (12) LP6HN PAR 100M 609A 120/277
Fixtures ship as multiple components using optimized packaging. Example above ships as:
(Qty 12) LP6HN PAR 100M 120/277 (12 cartons of one housing)
(Qty 12) 609A (12 cartons of one reflector)

Drawings are for dimensional detail only and may not represent actual mechanical configuration. Dimensions are shown in inches (centimeters) unless otherwise noted.

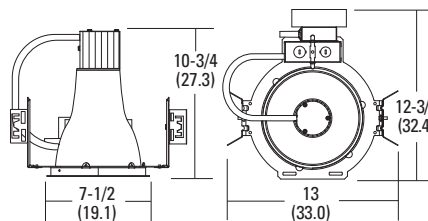

Notes

- 1 Damp lens available with 609 reflectors.
- 2 347V ballast only available with encased and potted electromagnetic ballast.
- 3 Lensed reflectors are wet location listed.
- 4 White painted flange standard.

LP6N



Intended Use
Ideal for a wide variety of low- to medium-height ceiling applications including commercial, retail and hospitality spaces where open, baffled, wallwash and lensed reflectors are required.

Construction
Heavy-gauge die-formed galvanized steel mounting frame. Attached to frame are vertically adjustable mounting brackets for use with C channels, 1/2" steel conduit

or flat hanger bars. Junction boxes equipped with two 3/4" and four 1/2" conduit knockouts with pryout slots and removable access doors.

Utilizes an extruded socket housing that attaches to the reflector via key hole mount, which provides superior heat dissipation and extended lamp life. Socket housing also adjusts to accommodate varying lamp lengths.

Maximum ceiling thickness 1-1/2".

Electrical
Durable medium-base porcelain socket with nickel-plated copper alloy screw shell and contact. Integral thermal protector provides protection against improper use of insulation materials. Rated for #12 AWG conductor through-branch wiring. Minimum 90°C supply wire. Ground wire provided.

Listings
Fixtures are UL Listed for through-branch wiring, Non-IC recessed mounting, damp location, and to U.S. and Canadian safety standards.



ORDERING INFORMATION

For shortest lead times, configure products using **bolded options**.

Example: LP6N 609A

Series	Reflector	Lens ¹	Options
LP6N	Choose reflector below. Housing and reflector may be ordered separately. Lamp types and maximum wattages are listed for each reflector.	CGL Clear glass lens T73 Tempered glass prismatic lens	SDT 277V stepdown transformer (277V to 120V) TRW White flange LBH Less barhangers
Open reflector		Wallwash with integral kicker	Glass lens (wet location)
609	White ¹	6W9 White	6LRF1 White splay, clear lens ^{2,3}
609A	Clear diffuse ¹	6W9A Clear diffuse	6LRFB1 Black baffle, clear lens ^{2,3}
609AZ	Clear semi-specular ¹	6W9AZ Clear semi-specular	6LR4 White splay, fresnel lens ^{2,3}
609G	Gold diffuse ¹	6W9G Gold diffuse	6LRB4 Black baffle, fresnel lens ^{2,3}
609GZ	Gold semi-specular ¹	6W9GZ Gold semi-specular	6LRF73 White splay, tempered prismatic lens ^{2,3}
609PR	Pewter diffuse ¹	6W9PR Pewter diffuse	6LRFB73 Black baffle, tempered prismatic lens ^{2,3}
609WTZ	Wheat semi-specular ¹	6W9WTZ Wheat semi-specular	
	150 A21 150 PAR38 120 BR40	150 A21 120 BR40	150 A21 150 PAR38 120 BR40

ADDITIONAL INFORMATION

For additional product information, visit www.lithonia.com.

STANDARD PACKAGING
To order, use single master catalog number.
Example: (13) LP6N 609A
Fixtures ship as multiple components using optimized packaging. Example above ships as:
(Qty 12) LP6N J6 (two cartons of six housings)
(Qty one) LP6N U (one carton of one housing)
(Qty 13) 609A (13 cartons of one reflector)

Drawings are for dimensional detail only and may not represent actual mechanical configuration. Dimensions are shown in inches (centimeters) unless otherwise noted.

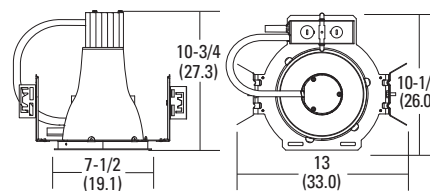

Notes

- 1 Damp lens available with 609 reflectors.
- 2 White painted flange standard (TRW).
- 3 Lensed reflectors are wet location listed.

PRODUCT INFORMATION

LV



Intended Use
New construction applications requiring high-performance vertical reflectors using low-voltage lamps.

Construction
Mechanical: Rugged, galvanized steel frame-in with trim retaining clips to secure optical system. Galvanized bar hangers span up to 24" o.c. and feature built-in nailers and T-bar clips. Galvanized steel junction box with removable access door, four Romex

knockouts, two 3/4" and four 1/2" nominal conduit knockouts with pryout slots.
Maximum ceiling thickness 1/2".

Electrical
Electrical System: Precision-wound step-down transformer with Class H insulation. For dimming control, use dimmers specifically designed for use with electromagnetic transformers. 75W MR16

maximum. Plug-in lamp connectors and snap-in socket cup. Two-pin porcelain socket with heat shield. Maximum 8 (4 in, 4 out) #12 AWG conductors. Rated 90°C supply wire. Ground wire provided. Thermally protected against improper contact with insulation and approved for through-branch circuit wiring.

Listings
Fixtures are UL Listed for through-branch wiring, non-

IC recessed mounting, damp location, and to U.S. and Canadian safety standards.

ORDERING INFORMATION For shortest lead times, configure products using **bolded options**.

Example: LV VMA2AZ 120

Series	Reflector ¹	Voltage
LV	Choose reflector below. Housing and reflector may be ordered separately. Lamp types and maximum wattages are listed for each reflector.	120 277 347

Adjustable cone	Baffle	Baffle adjustable	Baffle eyeball	Pinhole
VMA2AZ Clear semi-specular VMA2GZ Gold semi-specular VMA2BLZ Black semi-specular 75 MR16	VMB4 Black VMB4W White 75 MR16	VMA1 Black VMA1W White 75 MR16	VME4 Black VME4W White 75 MR16	VMS1 White with pinhole faceplate 75 MR16
VMA5 White with slotted faceplate 75 MR16	VPA2AZ Clear semi-specular VPA2GZ Gold semi-specular VPA2BLZ Black semi-specular 50 PAR36	VPA1 Black VPA1W White 50 PAR36	VPE2 Black VPE2W White 50 PAR36	

ADDITIONAL INFORMATION For additional product information, visit www.lithonia.com.

STANDARD PACKAGING
To order, use single master catalog number.
Example: (12) LV VMA2AZ 120
Fixtures ship as multiple components using optimized packaging. Example above ships as:
(Qty 12) LV 120 (12 cartons of one housing)
(Qty 12) VMA2AZ (12 cartons of one reflector)

Drawings are for dimensional detail only and may not represent actual mechanical configuration. Dimensions are shown in inches (centimeters) unless otherwise noted.

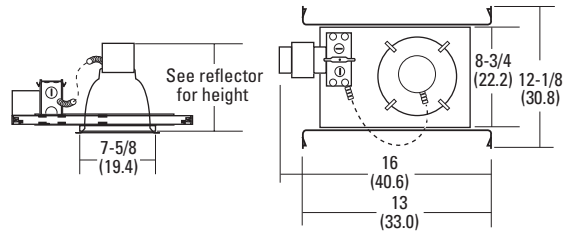

Notes
1 VM reflectors utilize a MR16.
VP reflectors utilize a PAR36.

Ballast/Transformer

ADALI	Advance® ROVR™ electronic controllable ballast utilizing digital addressable lighting interface (DALI) protocol. Requires four-pin lamp (120V or 277V only.)
ADCF	Advance electronic fluorescent ballast. Requires four-pin lamp (120V or 277V only.)
ADEZ	Advance Mark X® electronic line voltage control dimming ballast. (120V or 277V; 18DTT, 26DTT, 18TRT, 26TRT, 32TRT, 42TRT or 57TRT only.) Requires four-pin lamp. Minimum dimming level 5%.
ADZT	Advance Mark VII® electronic 0-10 VDC dimming ballast. (120V or 277V.) Requires four-pin lamp. Minimum dimming level 5%.
DMHL	LUTRON® Compact SE™ electronic three-wire line voltage control dimming ballast. (120V or 277V; 18DTT, 26DTT, 18TRT, 26TRT, 32TRT or 42TRT only.) Requires four-pin lamp. Minimum dimming level 5%.
OSCF	OSRAM SYLVANIA™ electronic fluorescent ballast. Requires four-pin lamp.
TUBCF	Universal Lighting Technologies™ electronic ballast. Requires four-pin lamp.
SDT	Stepdown transformer (277V to 120V; 300W max).
RIF1	Radio interference filter. Inductive capacitor circuit designed to minimize interference from feedback into line. (120V through 347V, 50 Hz or 60 Hz.)
BDP	Ballast disconnect plug meets codes that require in-fixture disconnect.
DS	Dual switching.

Emergency

EL	Emergency battery pack with remote test switch. Ships standard for one-lamp operation. For two-lamp emergency operation, consult installation instructions or factory.
ELR	Emergency battery pack with remote test switch. Ships standard for one-lamp operation. For two-lamp emergency operation, consult installation instructions or factory.
ELRHL	High lumen output emergency battery pack. Remote test switch provided.
ELRHL-42	Emergency battery pack with remote test switch. Operates two 42W CFL lamps in emergency mode with battery back-up in case of power disruption. Average output is 2,800 lumens for two 42W lamps.
ELRHL2LP	Emergency battery pack with remote test switch. Operates two 26W or two 32W CFL lamps in emergency mode with battery back-up in case of power disruption. Average output is 2,600 lumens for two 26W lamps; average output is 2,750 lumens for two 32W lamps.
BGTD	Bodine GTD™ generator transfer device. Factory installed on fixture; senses loss of normal power and switches to auxiliary generator to power fixture for egress lighting.

Fusing

GMF	Single, slow-blow fuse. (120V, 277V or 347V only.) For use with fluorescent fixtures only.
SF	Single fuse. (120V, 277V or 347V only.)

Trim

TRW	White painted flange.
TRBL	Black painted flange.

Lamp

WLP	Lamp (shipped separately).
LPSP	Spot lamp (shipped separately).
LPFL	Flood lamp (shipped separately).
LPWFL	Wide flood lamp (shipped separately).

		OPTIONS COMPATIBILITY													
		LF8N 1/TRT	LF8N 2/TRT	LF8N 2/DTT	LP8FN	LF6N 1/TRT	LF6N 2/DTT	LIF6	LP6FN	LP8HN	LP6HN	LP8N	LP6N	LV	
		Available (blank)	Not available												
Options - Must be ordered with housing or frame-in.															
BALLAST/ TRANSFORMER	ADALI	■	■	■	■	■	■	■	■	■	■	■	■	■	
	ADCF	■	■	■	■	■	■	■	■	■	■	■	■	■	
	ADEZ	■	■	■	■	■	■	■	■	■	■	■	■	■	
	ADZT	■	■	■	■	■	■	■	■	■	■	■	■	■	
	DMHL	■	■	■	■	■	■	■	■	■	■	■	■	■	
	OSCF	■	■	■	■	■	■	■	■	■	■	■	■	■	
	TUBCF	■	■	■	■	■	■	■	■	■	■	■	■	■	
	SDT												■	■	
	RIF1	■	■	■	■	■	■	■	■	■	■	■	■	■	
	BDP	■	■	■	■	■	■	■	■	■	■	■	■	■	
EMERGENCY	DS														
	EL	■	■	■	■	■	■	■	■	■	■	■	■	■	
	ELR	■	■	■	■	■	■	■	■	■	■	■	■	■	
	ELRHL	■	■	■	■	■	■	■	■	■	■	■	■	■	
	ELRHL-42		■	■	■	■	■	■	■	■	■	■	■	■	
	ELRHL2LP		■	■	■	■	■	■	■	■	■	■	■	■	
FUSING	GMF	■	■	■	■	■	■	■	■	■	■	■	■	■	
	SF									■	■	■	■	■	
TRIM	TRW	■	■	■	■	■	■	■	■	■	■	■	■	■	
	TRBL	■	■	■	■	■	■	■	■	■	■	■	■	■	
LAMP	WLP	■	■	■	■	■	■	■	■	■	■	■	■	■	
	LPSP									■	■	■	■	■	
	LPFL									■	■	■	■	■	
FPWFL															
MISCELLANEOUS	AT								■	■	■	■	■		
Accessories - Must be ordered separately.															
CEILING THICKNESS EXTENDER	CTE6									■	■	■	■	■	
	CTE8				■					■	■	■	■	■	
SLOPED CEILING ADAPTOR	SCA6							■	■	■	■	■	■	■	
	SCA8	■	■	■	■	■	■	■	■	■	■	■	■	■	
OVERSIZED TRIM RING	CTR6							■	■	■	■	■	■		

Miscellaneous

AT	Sealed airtight housing to minimize air flow through frame-in. Complies with WSEC and certified per ASTM E283.
----	--

Accessories

CTE6	Use when ceiling thickness is greater than 1"–1-1/2". Maximum thickness 2". For use with 6" vertical reflectors only.
CTE8	Use when ceiling thickness is greater than 1"–1-1/2". Maximum thickness 2". For use with 8" vertical reflectors only.
SCA	Sloped ceiling adaptor. Compatible with 8" and 6" commercial fixtures. Available in 5° increments, 10° to 30°. White only. See chart for fixture compatibility. Ex: SCA6 15D
CTR6	8-3/4" O.D. Use with F6 and 6 Series trims. Compatible with all 7-5/8" flanged trims only.

COLOR FILTERS/SPECIALTY LENSES	
For use on 6" low-voltage trims using a MR16 lamp. Not for use on 4" low-voltage trims. See page 373 for complete selection.	
F200 DB	Dark blue
F200 MA	Medium amber
F200 MB	Medium blue
F200 MG	Medium green
F200 MP	Medium pink
F200 RR	Ruby red
F200 UV	Ultra violet
F200 SL	Spread lens
F200 EG	Elongating lens
F200 SFG	Softening lens