

| LUMINAIRE SCHEDULE | | | | | | | | | |
|--------------------|-------|-----|------------------------------------|--|--|-----------------------------------|--------|------|-------|
| Symbol | Label | Qty | Catalog Number | Description | Lamp | File | Lumens | LLF | Watts |
| | C | 69 | TH 400M PA22L SCWA (LEG 8, SC=1.3) | OPEN ACRYLIC OPTICAL, 400 MH W/ GLASS LENS | ONE 400-WATT PULSE START COATED BT-37 METAL HALIDE, VERTICAL BASE-UP POSITION. | TH_400M_PA22L (LEG 8, SC=1.3).ies | 40000 | 0.72 | 458 |

| STATISTICS | | | | | | |
|---------------|--------|-------|-------|-------|---------|---------|
| Description | Symbol | Avg | Max | Min | Max/Min | Avg/Min |
| Floor Summary | + | 25 fc | 46 fc | 11 fc | 4.2:1 | 2.3:1 |
| rack vertical | + | 13 fc | 31 fc | 6 fc | 5.2:1 | 2.2:1 |

| POWER DENSITY STATISTICS | | | | |
|--------------------------|--------------|-------------|--------------|------------|
| Name | # Luminaires | Total Watts | Area | Density |
| Power Density Zone # 1 | 69 | 31602.00 W | 39253.14 ft² | 0.81 W/ft² |

- NOTES**
1. Readings shown are in units of maintained footcandles.
 2. Total light loss factor = See luminaire schedule
 3. Test plane = 0' aff
 4. Ceiling height = 28' aff
 5. Fixture mounting height = 26' aff
 6. Fixture spacing = See plan view.
 7. Reflectance = 50/30/20
 8. This photometrics layout was calculated using specific criteria, any deviation from stated parameters will effect actual performance.
 9. These lighting calculations are not a substitute for independent engineering analysis of lighting system suitability and safety.
 10. Racking= 16' high, 10% reflectance.

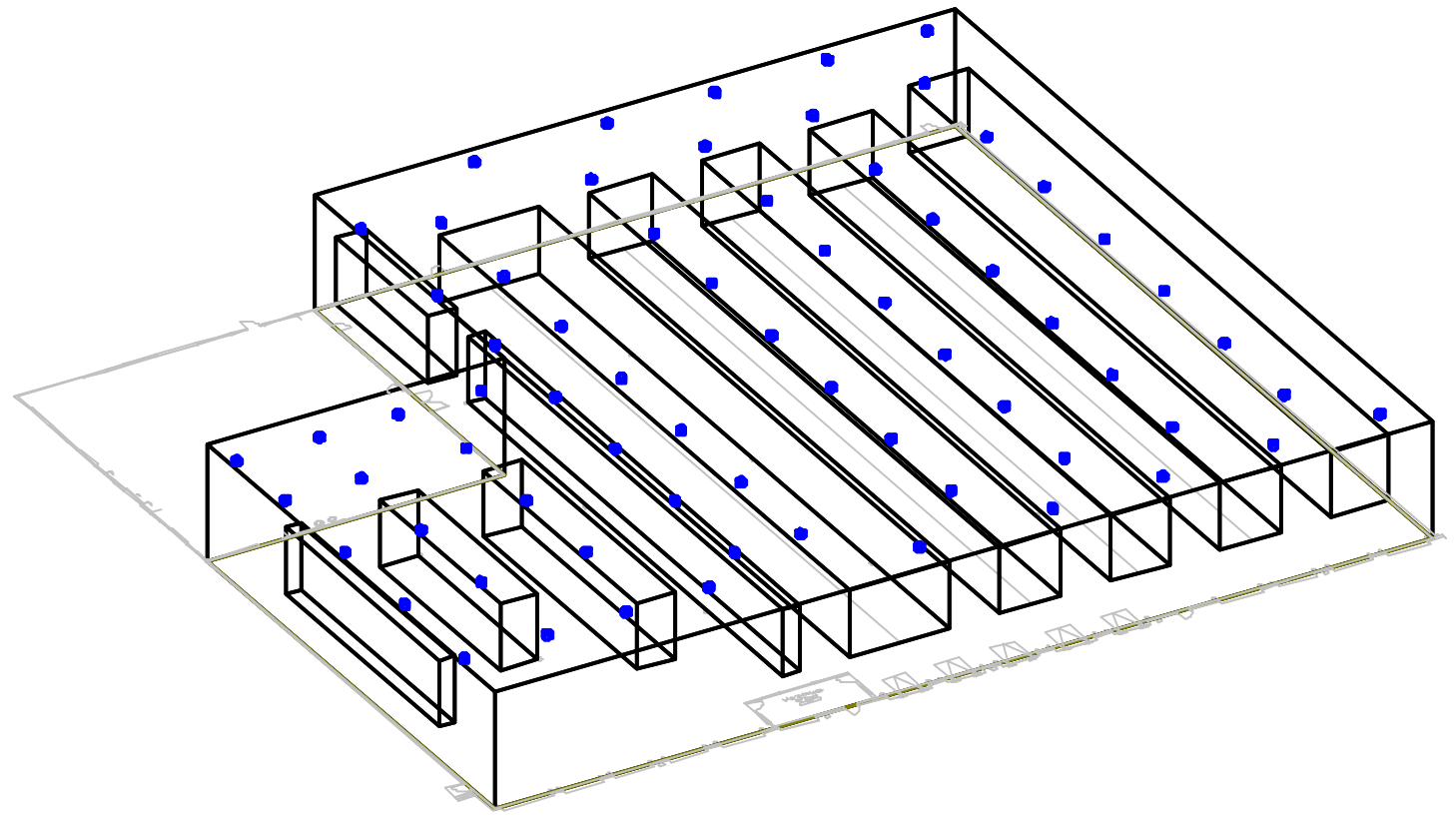

Southwest View
Not to Scale

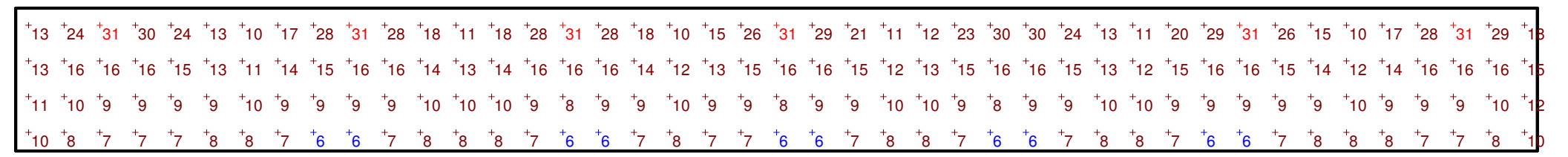

vertical on rack
Scale 1" = 16"

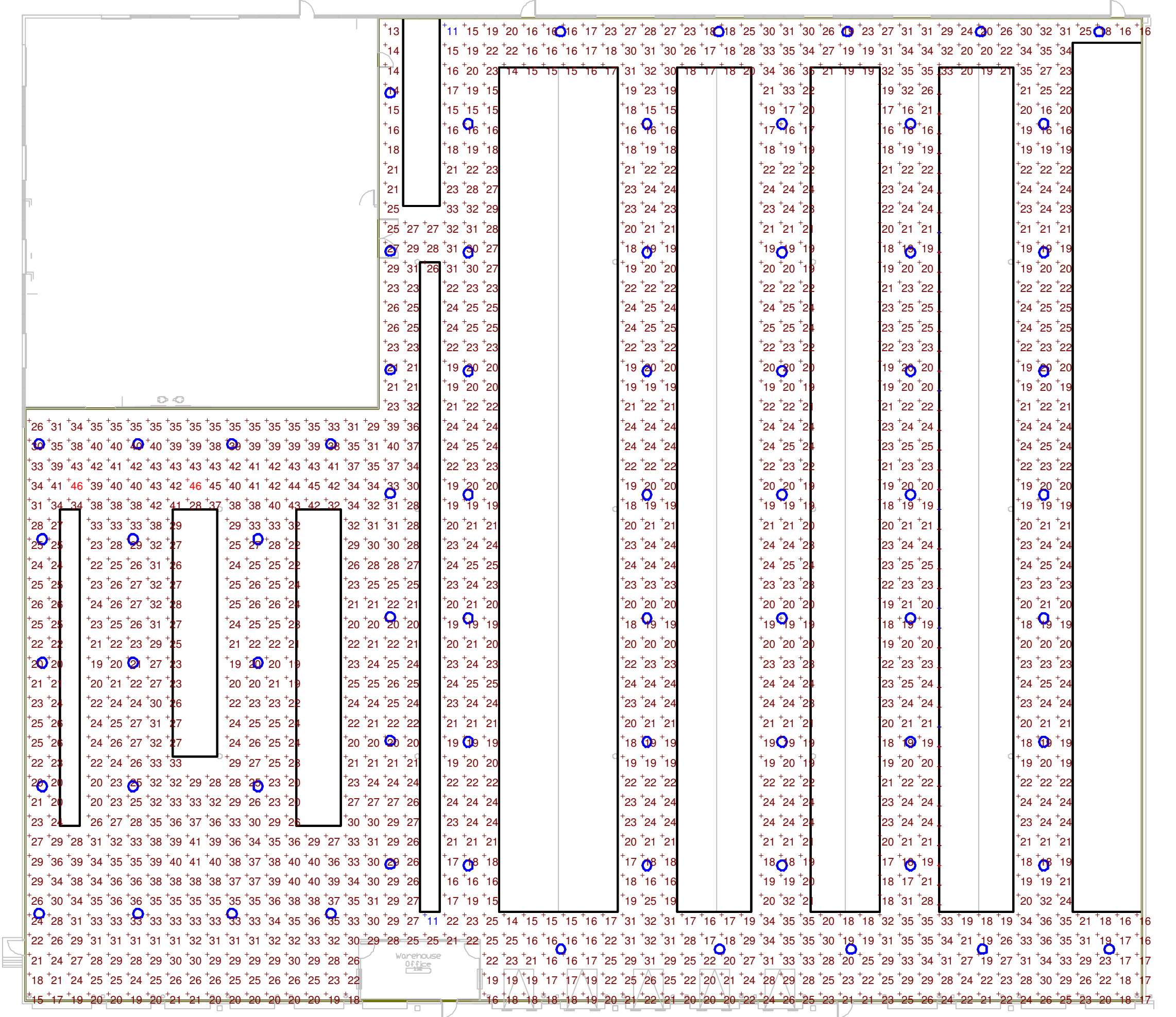

Plan View
Scale 1" = 20"

Calculated values include direct and interreflected components.