

WIRELESS KEYCARD INSTALLATION GUIDE

1. Decide where you want to mount the key card switch.

The ideal height is in line with wall switches (49" or 125 cm on center) for comfortable access.

NOTE: If installing over an existing wall box make sure any bare electrical wires are capped.

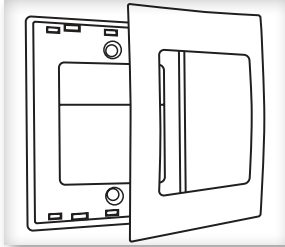

2. Remove the trim plate from the key card assembly.
3. Using a level and a pencil, lightly mark two small dots to align the upper edge of the key card switch.
4. Mount the key card switch securely to the wall using the provided screws and wall anchors.

- A. Using the pencil marks to ensure it's level, mark the two mounting screw drill points.
- B. Drill two holes for the wall anchors with a 3/16" drill bit and insert the wall anchors.
- C. Insert the top screw loosely and level the Key Card Switch.
- D. Insert the bottom screw, and then hand tighten the top screw.

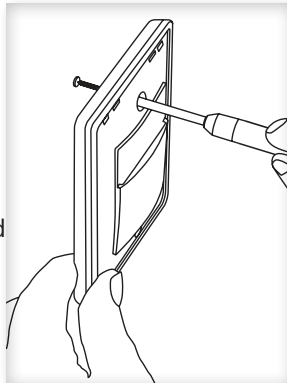

5. Insert the trim plate tabs into the bottom slots of the key card switch, and then lightly flex the trim plate to insert the top tabs.

TIP: To remove the trim plate without marking it, press down with a fingernail in the top groove to ease the tabs out of the slots.

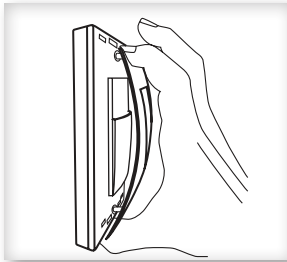

6. Insert a key card to test the mechanism.

TIP: There should be an audible click each time the key card is inserted or removed.

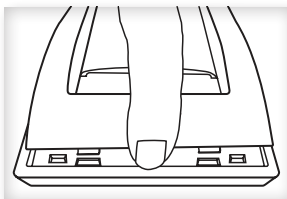

PAIR & PLAY TECHNOLOGY

STEP 1: Enter pairing mode. Double tap the xCella Remote Module user button to enter Override mode, then double tap again to enter Pairing mode. The Remote Module LED will blink rapidly.

Remote Module
user button

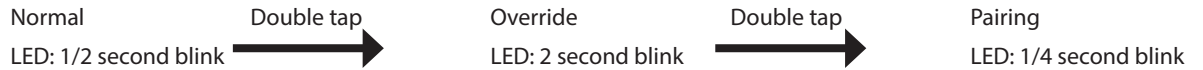

Notes:

- The relay blinks once after each pairing and twice after unpairing.
- The Module stays in pairing mode for 30 seconds after each pairing is complete.

STEP 2: Send switch pairing commands by inserting and remove card 3 times within 5 seconds¹. The Remote Module's relay will cycle once (light fixtures blink) each time a switch or sensor is successfully paired.



Insert and remove card 3 times within 5 seconds

Sending the pairing command a second time will unpair the switch from the Remote Module. The relay will cycle twice after a sensor or switch is unpaired.

STEP 3: Return to normal mode by double tapping the xCella Remote Module button once.

NOTES:

1. Up to 16 total switches and sensors can be paired to an xCella Remote Module.